

PRICE LIST
OF
SPARE PARTS
FOR
ARIEL
THE
MODERN
MOTOR CYCLE



650c.c. TWIN CYLINDER
HUNTMASER

ARIEL MOTORS LTD.
SELLY OAK BIRMINGHAM 29
Telephone: SELLY OAK 1381 Telegrams: ARIEL, SELLY OAK
Cables: ARIEL, SELLY OAK (ENGLAND)

Price Two Shillings

PRICE LIST
OF
SPARE PARTS
FOR
ARIEL
THE
MODERN
MOTOR CYCLE



650 c.c. TWIN CYLINDER
HUNTMASTER

ARIEL MOTORS LTD.

SELLY OAK BIRMINGHAM 29

Telephone: SELLY OAK 1381 Telegrams: ARIEL, SELLY OAK
Cables: ARIEL, SELLY OAK (ENGLAND)

Price Two Shillings

PRINTED BY ALLDAY LIMITED, BIRMINGHAM

PLEASE NOTE

The Latest Retail Prices only are shown in this Spares List. Prices and Part Numbers quoted in this book are those prevailing at the time of publication, but we reserve the right to revise prices and introduce any modification deemed necessary at any time without prior notice.

**650 c.c. TWIN CYLINDER
HUNTMASTER
Model FH**

Price Two Shillings

Ref. CWW/TCP

PUBLISHED JANUARY 1954

by

ARIEL MOTORS LTD.

SELLY OAK BIRMINGHAM 29

Telephone: SELLY OAK 1381 Telegrams: ARIEL, SELLY OAK
Cables: ARIEL, SELLY OAK (ENGLAND)

650 c.c. TWIN CYLINDER, MODEL FH

INDEX

	Page		Page
Air Cleaner	32	Handlebars	31
Ariel Dealers and Spares Stockists	37-42	Mudguard, Front	26
Brake Pedal and Fittings	29	Mudguard, Rear	29
Battery Carrier	31	Nuts, Washers, etc.	34
Cylinder and Fittings	9	Oil Pump	13
Cylinder Head and Fittings	9	Oil Tank	30
Clutch Assembly	19	Pistons	12
Chains and Chain Covers	29-30	Petrol Tank and Fittings	28
Carburetter	32-33	Rocker Assembly	9-10
Crankcase and Fittings	10-11	Shock Absorber (Engine Shaft)	12
Crankshaft Assembly	11-12	Steering Head Fittings	21
Dual Seat and Fittings	31	Speedometer	29
Engine Plates and Tie Bolts	13	Stand, Front	26
Exhaust System	30	Stand, Prop	15
Electrical Equipment	33	Stand, Centre	15
Footrests, Main	29	Tool Kit	31-32
Footrests, Pillion	29	Valves and Fittings	9
Frame	26-28	Wheel, Front	21-23
Front Fork Assembly	19-21	Wheel, Rear	23-25
Gear, Timing	13	Wheel, Detachable Rear	25-26
Gearbox	15-19		

NOTE.—The letters R/S and L/S mean the right-hand side and left-hand side respectively when the rider is on the saddle.

Standard nuts, washers, etc., are listed on page 34 and are not shown separately each time they occur with individual components. This avoids needless repetition.

VERY IMPORTANT

READ CAREFULLY BEFORE ORDERING SPARE PARTS

We recommend Ariel riders to obtain any spares which they may require through their local dealer. In case of difficulty, however, parts may be obtained direct from our Service Department.

NOTES ON ORDERING

Always send a Spare Parts Order on a separate sheet with name and address. Do not embody the order in a letter, although the letter and order can be sent in the same envelope. This procedure will avoid delay in the despatch of parts. **See Specimen Order Form on page 7.**

Give Spares Number and description of part. **Also quote Engine and Frame Numbers with prefix letters.** If there is any doubt concerning the part required, return the old part as pattern; this will not be returned with the new part unless asked for. The engine number and prefix letter will be found stamped upon the crankcase, drive side, immediately below the Cylinder Block. The frame number and prefix letter is stamped upon the head lug (left side).

The symbols R/S or O/S and L/S or N/S indicate the right-hand side and left-hand side respectively of the machine as indicated by the rider when sitting on the saddle.

If you have an account, the goods will be despatched as soon as possible after receipt of order. If you have no account, it will facilitate despatch if remittance to cover cost of goods, postage and packing is enclosed.

If you have no account and remittance is not enclosed, we shall be pleased to despatch per C.O.D. post or send Pro Forma Invoice as instructed.

When telegraphing a money order, do not fail to give your name and address, and concise particulars of your requirements.

Goods returned must be sent carriage paid, and relatively fragile parts, such as cylinders, etc., should be very securely packed to avoid damage. Label parts returned with name and address of sender.

We are pleased to give estimates for overhauls and repairs, but cannot give firm quotations as necessities may be discovered not foreseen when estimating.

Should an estimate not be accepted, payment for dismantling and reassembling must be made.

**PREFIX LETTERS TO ENGINE AND
FRAME NUMBERS**

To give the engine or frame number without the prefix letters is useless, as the numbers repeat from year to year and also on each capacity class. The **prefix letters** indicate both year of manufacture and capacity of engine and must, therefore, always be included with the actual figures so that the machine may be completely identified.

Engine prefix letter and number is stamped on the drive side of crankcase just below cylinder base. Frame letter and number is stamped on the head lug (left side).

SPECIMEN ORDER FORM

For use in Great Britain only

A clearly worded order is the best way to ensure prompt and accurate despatch of spares. We therefore suggest that orders should be made out in the following manner:

To: (Name and address of your usual dealer),

Customer's Address.

or: Ariel Motors Ltd.,
Selly Oak,
Birmingham 29.

Dear Sirs,

Kindly forward the following parts against cash (state amount) enclosed.

or Kindly forward the following parts per C.O.D. post.

or Kindly forward Pro Forma Invoice for the following:

For Model..... Year..... Engine No. and **Prefix Letter.**

Quantity	Spares No.	Description	Price

Add 5% surcharge to net amount of Invoice to cover postage and carriage. Cases charged extra.

Total Cost _____

Sign your name **clearly.**

EXPLODED VIEW OF ROCKER BOX AND CYLINDER HEAD

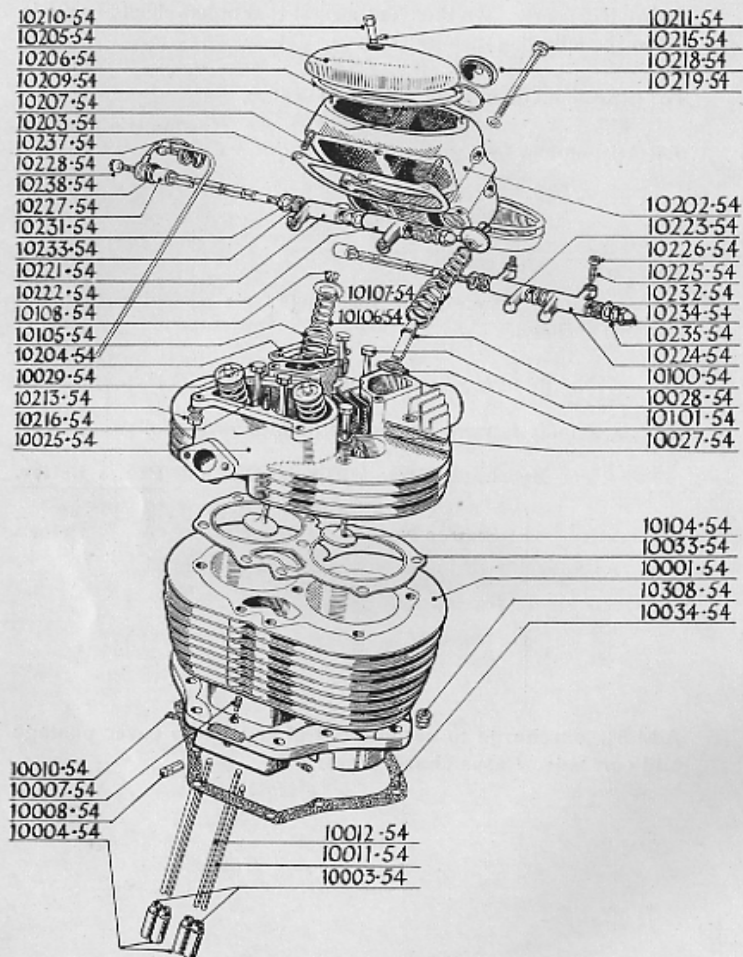

ARIEL 650 c.c. TWIN CYLINDER HUNTMASTER

Order by SPARES No.	Do not use PART No.	DESCRIPTION OF PART	No. per Set	PRICE EACH £ s. d.
CYLINDER AND FITTINGS				
10001-54	45-2589	Cylinder barrel (K302)	1	7 0 0
10003-54	67-332	Tappet (inlet)	2	8 0
10004-54	67-333	Tappet (exhaust)	2	9 0
10007-54	67-276	Tappet securing screw	1	1
10008-54	67-331	Tappet locating pin (exhaust)	1	1 0
10009-54		Tappet locating pin ball ($\frac{1}{16}$ in.)	1	1
10010-54	67-299	Tappet retaining screw	2	1
10011-54	67-360	Push rod complete (inlet)	2	4 6
10012-54	67-362	Push rod complete (exhaust)	2	4 6
10034-54	67-256	Cylinder base washer	1	2
CYLINDER HEAD AND FITTINGS				
10025-54	45-2588	Cylinder head, fitted valve guides (K371)	1	9 18 0
10027-54	67-258	Cylinder head bolt (medium)	2	10
10028-54	67-283	Cylinder head bolt (short)	3	8
10029-54	67-254	Cylinder head bolt (long)	4	10
10030-54	EB-76	Washer for cylinder head bolt	9	1
10033-54	67-255	Cylinder head gasket	1	4 0
10035-54	65-1232	Carburettor flange joint washer	1	1
10036-54	EB-70	Carburettor fixing bolt	2	6
10037-54	36-382	Carburettor fixing bolt washer	2	1
10038-54	67-120	Carburettor drip shield	1	1 0
10042-54	E9/3232	Torque stay, R/S	1	2 6
10043-54	E9/3233	Torque stay, L/S	1	2 6
10044-54	E9/3234	Clip for torque stay	2	1 6
0625	C20/29	Bolt for torque stay clip	2	2
S19-3		Washer	2	7
S1-3		Nut	2	2
GS120-54		SET JOINT WASHERS AND GASKETS per set	7	3
VALVES AND FITTINGS				
10100-54	67-31	Valve guide	4	4 6
10101-54	67-33	Valve spring cup	4	1 4
10103-54	67-323	Inlet valve	2	15 0
10104-54	67-324	Exhaust valve	2	15 0
10105-54	67-439	Valve spring (outer)	4	1 3
10106-54	67-440	Valve spring (inner)	4	6
10107-54	67-34	Valve spring collar (top)	4	1 4
10108-54	29-410	Split cone (two halves)	4	1 0
ROCKER BOX AND FITTINGS				
10202-54	45-2595	Rocker box (K307)	1	1 14 0
10203-54	45-2622	Rocker box joint washer (inlet, rear) (K358)	1	5
10204-54	67-277	Rocker box joint washer (exhaust, front)	2	3
10205-54	45-2596	Rocker box inspection cover (K308)	2	5 0
10206-54	45-2623	Rocker box inspection cover joint washer (K356)	2	1 0
10207-54	67-347	Rocker box and steady stay stud	4	4
10209-54	45-2620	Stud for rocker box cover (K324)	2	5
10210-54	45-2624	Nut for rocker box cover (K14A)	2	6
10211-54	45-2625	Circlip, rocker box cover nut (K148-48)	2	1
10212-54	45-2626	Peg for inspection cover (K36)	4	1
10213-54	EA-80	Nut for rocker box stud	2	4
10214-54	36-382	Shakeproof washer for rocker box stud	4	1

Order by SPARES No.	Do not use PART No.	DESCRIPTION OF PART	No. per Set	PRICE EACH	
				£	s. d.
10215-54	67-261	Bolt (long) for rocker box ..	4	1	0
10216-54	45-2621	Stud, cylinder head to rocker box (K360)	1	7	
10217-54	24-8784	Washer (1/8 in. spring) for rocker box bolt	5	1	
10213-54	EA-80	Nut for stud 10216-54 ..	1	4	
10218-54	45-2627	Rocker box cap nut (ET428A) ..	1	2	3
10219-54	45-2628	Rocker box cap nut joint washer (K359) ..	1	2	
10221-54	67-264	Rocker lever (inlet) L/S ..	1	11	0
10222-54	67-265	Rocker lever (inlet) R/S ..	1	11	0
10223-54	67-266	Rocker lever (exhaust) L/S ..	1	11	0
10224-54	67-267	Rocker lever (exhaust) R/S ..	1	11	0
10225-54	67-56	Rocker adjusting screw ..	4	1	0
10226-54	24-563	Rocker adjusting screw nut ..	4	4	
10227-54	67-64	Rocker spindle ..	2	10	0
10228-54	65-317	Oil feed pipe union screw ..	2	1	0
10231-54	67-60	Thrust washer, flat (large hole) for rocker spindle ..	6	2	
10232-54	67-61	Thrust washer, flat (small hole) R/S, for rocker spindle ..	2	2	
10233-54	67-62	Spring washer for rocker spindle ..	4	1	
10234-54	65-311	Domed nut for rocker spindle ..	2	6	
10235-54	36-481	Washer for rocker spindle domed nut ..	2	2	
10237-54	45-2637	Rocker oil feed pipe complete (K378) ..	1	9	0
10238-54	15-203	Fibre washer for oil pipe union ..	2	1	
10239-54	24-6040	Thin nut for rocker box steady ..	4	4	

CRANKCASE AND FITTINGS

10300-54	K/373	Crankcase (two halves with fixed fittings)	1	13	10	0
10303-54	45-2613	Inner timing cover (K376) ..	1	18	6	
10304-54	45-2614	Outer timing cover (K377) ..	1	1	10	0
10307-54	67-74	Stud, cylinder barrel fixing ..	10	4		
10308-54	24-5160	Nut for crankcase and cylinder barrel stud	10	4		
10309-54	36-382	Washer for crankcase and cylinder barrel stud ..	10	1		
10310-54	67-1288	Joint washer for sump cover ..	1	1		
10311-54	31-222	Stud for sump cover ..	4	4		
10312-54	29-541	Washer for sump cover stud ..	4	1		
10313-54	EB-113	Nut for sump cover stud ..	4	2		
10314-54	45-2658	Oil sump cover complete (K335) ..	1	4	0	
10315-54	67-130	Crankcase breather ..	1	7	0	
10319-54	67-134	Crankcase breather washer (cork), 1/4 in. thick ..	1	2		
10320-54	67-135	Crankcase breather washer (cork), 3/8 in. thick ..	1	2		
10321-54	67-136	Crankcase breather washer (cork), 1/2 in. thick ..	1	2		
10322-54	67-137	Crankcase breather washer (cork), 5/8 in. thick ..	1	2		
10323-54	67-674	Crankcase oil seal ..	1	1	6	
10329-54	67-670	Roller bearing, drive side (R130L) ..	1	1	7	0
10330-54	67-648	Crankshaft bearing, gear side ..	1	10	0	
10331-54	67-686	Bush for timing case ..	1	4	6	
10331-54	67-686	Camshaft bush ..	3	4	6	
10332-54	67-1236	Crankcase dowel ..	1	3		
10333-54	27-1589	Crankcase and timing cover dowel (timing cover) ..	2	2		
10334-54	67-1395	Stud for oil pump fixing (long) ..	2	3		
10335-54	67-1396	Stud for oil pump fixing (short) ..	1	3		
10336-54	67-355	Crankcase stud top ..	1	6		
10337-54	67-1245	Stud for magneto fixing (1 1/8 in. x 5/16 in.)	3	4		

Order by SPARES No.	Do not use PART No.	DESCRIPTION OF PART	No. per Set	PRICE EACH		
				£	s. d.	
10338-54	67-138	Plug for inner timing cover ..	1	2		
10340-54	67-286	Bush for idler pinion spindle ..	1	4	0	
10341-54	45-2645	Joint washer for inner timing cover (K366) ..	1	4		
10342-54	67-133	Screw for inner timing cover (1 in. x 1/4 in.)	4	4		
10344-54	67-721	Dynamo driving sprocket complete ..	1	7	0	
10345-54	35-4224	Lock washer for dynamo driving sprocket	1	1		
10346-54	EB-106	Nut for dynamo driving sprocket ..	1	4		
10348-54	67-727	Dynamo driven sprocket, 11T ..	1	4	0	
10349-54	67-729	Dynamo sprocket lock washer ..	1	1		
10351-54		Dynamo cork washer (supplied by Lucas)	1	6		
10352-54		Dynamo sprocket nut (supplied by Lucas)	1	6		
10353-54	67-296	Dynamo driving chain (8 mm. x 52 pitches)	1	7	0	
10355-54	45-2646	Joint washer for outer timing cover (K367)	1	4		
10356-54	66-3074	Outer timing cover dowel ..	2	4		
10357-54	45-2649	Screw (short) for outer timing cover (inter. 015) ..	3	7		
10358-54	45-2648	Screw (medium) for outer timing cover (inter. 014) ..	4	7		
10359-54	45-2647	Screw (long) for outer timing cover (K352)	5	6		
10365-54	45-2651	Oil return pipe complete (K329) ..	1	4	0	
10367-54	45-2656	Bolt for fixing oil return pipe (K357) ..	1	2		
10368-54	67-1281	Lock washer for 10367-54 bolt ..	1	1		
10369-54	67-1502	Oil release valve assembly complete ..	1	14	0	
10370-54	67-1503	Oil release valve body and gauze ..	1	6	0	
10371-54	67-1505	Plug for valve release body ..	1	8		
10372-54	67-1498	Washer for valve release plug ..	1	1		
		3/8 in. ball for release valve ..	1	1		
10374-54	67-1496	Spring for release valve ..	1	3		
10375-54	67-1499	Fibre washer for release valve ..	1	1		
10376-54	45-2660	Oil pipe union (delivery and return) (Inter. 5890-51) ..	2	1	0	
10377-54	45-2661	Strap for dynamo fixing (K383) ..	2	1	3	
10378-54	45-2662	Swivel pin (tapped hole) for battery strap (K384) ..	1	8		
10379-54	65-2352	Swivel pin (plain hole) for battery strap ..	1	8		
10380-54		Bolt for battery strap ..	1	6		
10381-54	29-4662	Washer for bolt ..	1	6		
10382-54	67-353	Stud securing dynamo fixing strap ..	2	3		
10384-54	67-1258	Magneto joint washer ..	1	1		
10388-54	24-5160	Nut for magneto fixing ..	2	4		
10386-54	K/386	Long nut for magneto fixing ..	1	2	6	
10387-54	36-3821	Washer for nuts ..	3	1		
10388-54	67-1400	Spring for internal non-return valve ..	1	1		
		1/2 in. ball for internal non-return valve ..	1	1		
10389-54	67-1401	Grab screw for internal non-return valve	1	2		
10390-54		Breather pipe complete ..	1	4	9	

CRANKSHAFT ASSEMBLY

10401-54	67-664	Crankshaft and flywheel assembly ..	1	10	10	0
10404-54	65-615	Crankshaft oil hole grab screw ..	2	4		
10405-54	67-301	Bolt for flywheel ..	6	5		
10406-54	67-302	Nut for flywheel bolt ..	6	2		
10407-54	15-5155	Washer for flywheel bolt ..	6	1		
10410-54	67-317	Connecting rod (drive side), c/w bushes, bolts and nuts ..	1	2	11	6
10411-54	67-268	Connecting rod (gear side), c/w bushes, bolts and nuts ..	1	2	11	6
10414-54	67-298	Small end bush ..	2	2	6	
10415-54	67-226	Con. rod big end bush ..	3	7	0	

Order by SPARES No.	Do not use PART No.	DESCRIPTION OF PART	No. per Set	PRICE EACH £ s. d.
10416-54	67-320	Con. rod big end bush (drilled) .. halves	1 ..	7 0
10417-54	67-1033	Bolt for connecting rod big end ..	4 ..	2 6
10418-54	67-297	Washer for connecting rod bolt ..	4 ..	1
10419-54	67-1034	Nut for connecting rod bolt ..	4 ..	1 0
10420-54	35-702	Split pin for connecting rod bolt ($\frac{1}{16}$ in. \times $\frac{3}{8}$ in.) ..	4 ..	1
10421-54	67-671	Shim for crankshaft, .005 in. thick as reqd. - ..	2	2
10422-54	67-672	Shim for crankshaft, .010 in. thick as reqd. - ..	2	2
10423-54	67-349	Shim for drive side bearing ..	1 ..	1
10425-54	67-339	Crankshaft pinion ..	1 ..	5 0
10426-54	67-642	Crankshaft gear for oil pump ..	1 ..	5 6
10427-54	67-645	Washer for crankshaft gear ..	1 ..	1
10428-54	15-40	Crankshaft pinion key ..	1 ..	4
10429-54	67-643	Crankshaft nut ..	1 ..	4
10430-54	67-644	Crankshaft nut lock washer ..	1 ..	1
10431-54	67-666	Grub screw for crankshaft..	1 ..	4

SHOCK ABSORBER AND ENGINE SPROCKETS

10451-54	45-2663	Engine sprocket, 22T (K320) ..	1 ..	1 1 9
10452-54	45-2664	Engine sprocket, 24T (K322) ..	1 ..	1 2 6
10456-54	67-2054	Shock absorber nut ..	1 ..	2 6
10457-54	67-2055	Sliding member ..	1 ..	7 0
10458-54	67-2062	Shock absorber spring ..	1 ..	3 0
10459-54	67-2071	Shock absorber sleeve (splined) (K389) ..	1 ..	12 0
10460-54	67-2056	Alignment shim for engine sprocket, .005 in. thick .. as reqd. - ..	1	1
10461-54	67-2057	Alignment shim for engine sprocket, .010 in. thick .. as reqd. - ..	1	1
10462-54	67-2058	Alignment shim for engine sprocket, .030 in. thick .. as reqd. - ..	1	1
10463-54	35-709	Split pin for shock absorber nut ..	1 ..	1

PLEASE NOTE

The following parts are fitted to Model FH, 2nd Series

10470-54	45-2774	Engine sprocket, 22T ..	1 ..	1 1 9
10471-54	45-2775	Engine sprocket, 24T ..	1 ..	1 2 6
10472-54	45-2772	Shock absorber nut ..	1 ..	2 6
10473-54	67-1135	Sliding member ..	1 ..	7 0
10474-54	67-1136	Shock absorber spring ..	1 ..	3 0
10475-54	67-1134	Shock absorber sleeve (splined) ..	1 ..	12 0
10476-54	45-2773	Distance collar (K390) ..	1 ..	1 9

PISTONS AND FITTINGS

10501-54	67-423	Piston (comp. ratio 6-5-1) complete with rings, gudgeon pin and circlips ..	2 ..	1 8 10
10502-54	67-424	Piston only (comp. ratio 6-5-1) ..	2 ..	18 6
10503-54	67-429	Piston (comp. ratio 7-25-1) complete with rings, gudgeon pin and circlips ..	2 ..	1 15 4
10504-54	67-430	Piston only (comp. ratio 7-25-1) ..	2 ..	1 4 0
10505-54	67-311	Piston ring (compression) ..	4 ..	1 11
10506-54	67-314	Piston ring (scraper) ..	2 ..	2 8
10507-54	65-440	Gudgeon pin ..	2 ..	4 6
10508-54	66-954	Gudgeon pin circlip ..	4 ..	2

EXPLODED VIEW OF CRANKCASE, OIL PUMP AND SHOCK ABSORBER ASSEMBLY

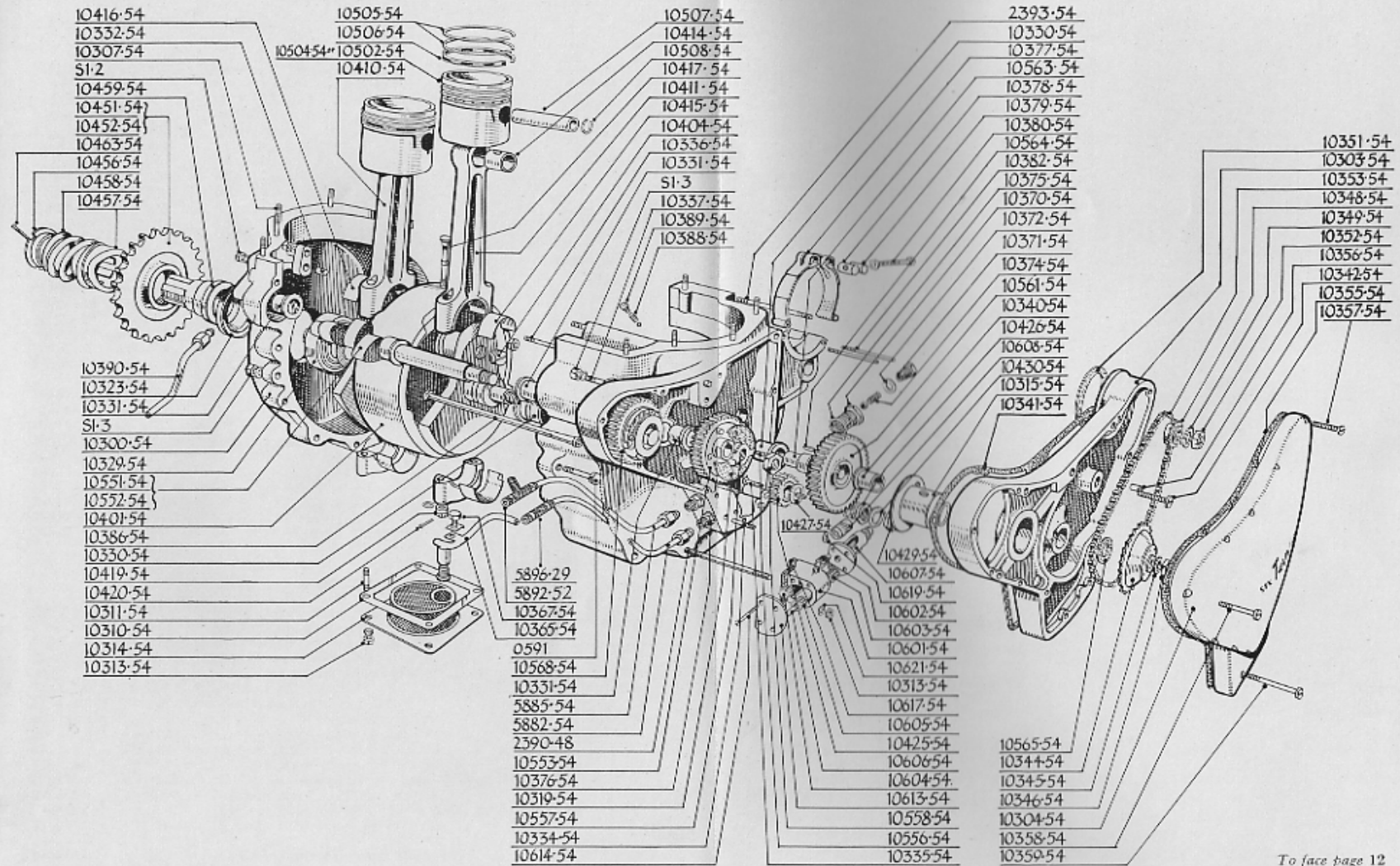

ARIEL 650 c.c. TWIN CYLINDER HUNTMASER

To face page 12

Order by SPARES No.	Do not use PART No.	DESCRIPTION OF PART	No. per Set	PRICE EACH		
				£	s.	d.
TIMING GEAR						
10551-54	67-334	Camshaft	1	2	3	0
10552-54	67-356	Camshaft (Canadian and U.S.A. markets only)	1	2	3	0
10553-54	67-337	Camshaft driving pinion complete	1	10	6	
10556-54	35-1896	Key for camshaft pinion	1			4
10557-54	67-685	Lock washer for camshaft pinion	1			1
10558-54	24-7000	Nut for camshaft pinion	1			4
10561-54	67-335	Idler pinion complete	1	16	4	
10562-54	67-336	Idler pinion only	1	10	0	
10563-54	67-707	Idler pinion spindle	1	6	0	
10564-54	27-1386	Idler pinion key	1			4
10565-54	67-708	Idler pinion spindle oil seal	1			1
10568-54		Auto-advance unit	1	1	2	6

OIL PUMP

10600-54	67-1381	Oil pump complete	1	1	15	0
10601-54	67-1382	Oil pump body	1			8 0
10602-54	67-1383	Oil pump feed gear (driver)	1			5 0
10603-54	67-1384	Oil pump feed gear (driven)	1			2 6
10604-54	67-1385	Oil sump gear (driver)	1			3 6
10605-54	67-1386	Oil sump gear (driven)	1			3 0
10606-54	67-1387	Oil sump driven gear spindle	1			4
10607-54	67-1388	Oil pump driving spindle housing	1			8 0
10608-54	67-1389	Oil pump driving spindle	1			3 0
10611-54	S-173	Oil pump driving spindle housing washer	1			1
10612-54	67-1390	Driving spindle spring ring	1			3
10613-54	67-1391	Oil pump end plate	1			1 0
10614-54	67-1392	Oil pump end plate screw	4			2
10617-54	67-1393	Oil pump joint washer	1			1
10619-54	67-1394	Oil pump joint washer (small)	1			1
10313-54	EB-113	Oil pump securing nut	3			2
10621-54	29-541	Oil pump securing nut washer	3			1

ENGINE PLATES AND TIE BOLTS

2303-54	K/309	Front engine plate	2			3 6
2307-54	E9/3116	Rear engine plate, R/S	1			10 6
2308-54	E9/3117	Rear engine plate, L/S	1			10 6
2318-54	E9/3201	Front cover for engine plate	1			3 6
048	K/365	Screws for engine plate cover	2			1
2330-54	E9/3054	Gearbox adjuster bolt	1			1 0
2336-35	E9/547	Gearbox adjuster bolt nut	1			1 0
0963	E9/3190	Tie bolt, front engine fixing (top)	1			2 0
0743	E9/3193	Tie bolt, front engine fixing (bottom)	1			2 0
0917	E9/413	Tie bolt (½ in. × 4½ in. × 20 T.P.I.)	2			10
2382-54	E9/3047	Gearbox pivot stud	1			1 6
2383-54	E9/3252	Nut for gearbox stud	1			6
2384-54	E9/3046	Gearbox pivot stud distance piece	2			2 0
2385-54	E9/3191A	Distance tube assembly, front fixing (top)	1			4 0
2386-54	E9/3194A	Distance tube assembly, front fixing (bottom)	1			4 0
2390-48	45-2639	Tie bolt (crankcase, rear) (K93-48)	5			10
2391-54	45-2640	Tie bolt (crankcase, front) (K325)	3			1 0
0591	E8/156	Bolt	2			10
2393-54	45-2642	Tie bolt (¾ in. × ⅝ in.) (K327)	1			1 0

EXPLODED VIEW OF GB GEARBOX

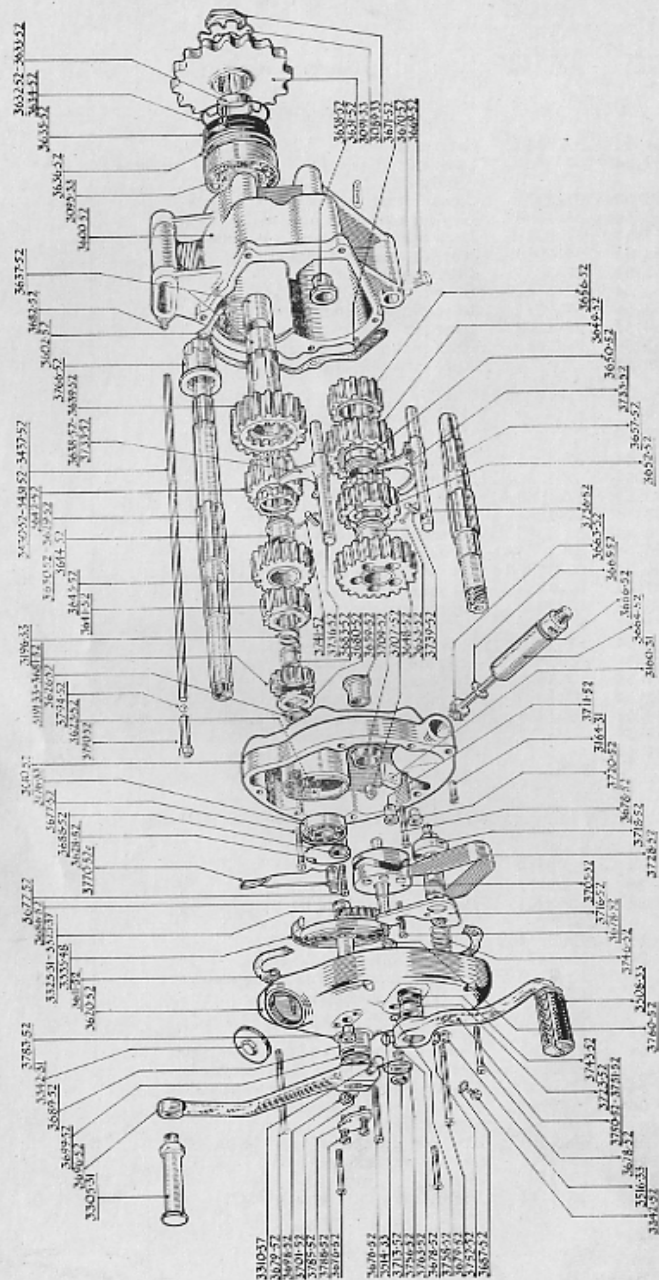

Order by SPARES No.	Do not use PART No.	DESCRIPTION OF PART	No. per Set	PRICE EACH
PROP STAND				
2450C-54	E9/1533C	Prop stand complete	1	14 6
2450-54	E9/1533	Prop stand leg	1	12 6
2465-53	E9/1374	Pivot pin	1	8
2461-52	E9/1375	Spring for prop stand	1	1 0
S2-5		Locknut, $\frac{1}{16}$ in.	1	4
GENTRE STAND				
2500-54	E9/3030A	Centre stand	1	1 2 6
2502-54	E9/3060	Pivot pin for centre stand	2	10
S19-6		Washer for pivot pin	4	2
2503-54	1400	Circlip	4	5
2504-54	E9/3072	Spring for centre stand	2	2 0
2505-54	E9/3042	Rubber stop	1	5
GEARBOX PARTS (GB33)				
Makers of Gearbox: Messrs. BURMAN & SONS LTD., Wychall Lane, Kings Norton, Birmingham 30				
(Model FH)				
3600-52	G-1-5	Gearbox shell only	1	2 5 0
3602-52	G-5-7	Gearbox joint washer	1	1
3610-52	G-2-4	Kick-starter case	1	1 5 0
3611-52	G-5-8	Kick-starter case joint washer	1	1
3620-52	G-3-4	Kick-starter case cover	1	1 5 0
3623-52	28-12-19	Kick-starter case cover locating piece	1	1 6
3626-52	11-7-10	Mainshaft nut (K.S. end)	1	6
3176-33	38-7-1	Mainshaft bearing	1	18 9
3628-52	31-11-1	Bearing retaining ring for mainshaft bearing	1	6
3630-52	G-18-5	Mainshaft	1	1 7 6
3631-52	G-31-5	Driving sprocket ($\frac{3}{8}$ in. \times $\frac{3}{8}$ in. \times 19T)	1	1 2 6
3632-52	28-12-16	Sprocket spacing collar	1	1 6
3095-33	38-11-1	Driving gear bearing	1	1 2 6
3634-52	31-12-2	Bearing retaining ring (split)	1	6
3635-52	27-12-2	Driving gear oil seal	1	4 6
3636-52	39-12-1	Driving gear oil seal housing	1	2 6
3089-33	11-11-1	Driving gear nut	1	2 7
3091-33	12-11-1	Driving gear nut lock washer	1	9
3637-52	19-8-13	Driving gear bush price per set of 2	2	6 0
3638-52	G-6-2	Driving gear with bush, 28T	1	2 8 0
3641-52	G-12-2	First gear (mainshaft), 17T	1	15 0
3642-52	G-10-2	Second gear (mainshaft), 22T	1	1 18 6
3643-52	G-8-1	Third gear (mainshaft), 25T	1	1 1 0
3644-52	19-8-15	Third gear (mainshaft), bush	1	5 0
3648-52	G-13-2	First gear (layshaft), 29T	1	1 1 0
3649-52	G-11-2	Second gear (layshaft), 24T	1	1 1 0
3650-52	19-8-15	Second gear (layshaft), bush	1	5 0
3652-52	G-9-1	Third gear (layshaft), 21T	1	1 18 6
3653-52	19-8-14	First gear (layshaft), bush	1	5 0
3656-52	G-7-2	Layshaft pinion, 18T	1	15 0
3657-52	G-19-4	Layshaft	1	1 10 0
3658-52	20-7-1	Layshaft bush (clutch end)	1	6 0
3659-52	20-7-3	Layshaft bush (K.S. end)	1	6 0
3660-52	35-1-2	Layshaft bush dowel	2	2
3661-52	12-8-8	Layshaft cover washer	1	4

Order by SPARES No.	Do not use PART No.	DESCRIPTION OF PART	No. per Set	PRICE EACH £ s. d.
3663-52	G-55-1	Speedometer spindle	1	15 0
3664-52	19-3-1	Speedometer spindle bush	1	10 0
3665-52	12-3-6	Speedometer thrust washer	1	4
3160-31	40-1-1	Speedometer location button	1	9
3666-52	27-6-2	Speedometer spindle bush oil seal	1	4
3164-31	26-3-1	Speedometer spindle bush grub screw	1	2
1596-33	ET/428	Gearbox filler plug	1	2 3
3669-52	21-7-5	Gearbox drain plug	1	9
3670-52	12-7-6	Gearbox drain plug washer	1	1
3671-52	35-3-2	Gearbox and K.S. case dowel	1	4
3676-52	14-2-3	Screw (K.S. cover to K.S. case)	2	6
3677-52	14-2-4	Screw (K.S. case to gearbox)	2	9
3678-52	14-2-5	Screw (K.S. case to gearbox and K.S. cover to K.S. case)	4	9
3679-52	14-2-6	Screw (K.S. cover to gearbox)	2	1 0
3682-52	35-3-5	Gearbox adjuster pivot pin	1	6
3342-52	21-5-1	Oil level plug	1	9
3687-52	12-5-4	Oil level plug washer	1	1
3068-50	11-7-1	Mainshaft nut (clutch end)	1	9
3070-50	12-7-9	Mainshaft nut lock washer (clutch end)	1	9
3675-52	35-1-1	Dowel (K.S. case cover locating piece)	2	3
3680-52	G-21-2	Driving ratchet	1	8 8
3191-33	G-20-1	Ratchet pinion	1	12 0
3196-33	36-8-2	Ratchet pinion spring	1	3 9
3683-52	19-7-3	Ratchet pinion bush	1	1 1
3325-31	G-22-1	Kick-starter quadrant	1	15 9
3686-52	G-23-1	Kick-starter quadrant spindle	1	11 3
3688-52	20-7-2	Kick-starter spindle bush (inner)	1	3 0
3689-52	20-8-14	Kick-starter spindle bush (outer)	1	3 0
3335-48	36-8-1	Kick-starter spring	1	4 0
3690-52	35-2-1	Kick-starter spring pin	1	6
3696-52	G-43-7	Kick-starter lever	1	15 9
3305-31	G-45-1	Kick-starter lever pedal	1	4 6
3307-35	E9/562	Kick-starter lever pedal rubber	1	1 1
3310-37	10-4-1	Kick-starter lever pinch bolt	1	1 1
3698-52	11-4-1	Kick-starter lever pinch bolt nut	1	9
3699-52	27-7-5	Kick-starter spindle oil seal	1	3 6
3701-52	12-4-1	Kick-starter lever bolt washer	1	2
3705-52		Cam assembly	1	1 10 0
3707-52	G-42-1	Cam plunger	1	2 0
3709-52	36-2-1	Cam plunger spring	1	6
3711-52	20-4-1	Cam spindle bush (inner)	1	2 6
3713-52	11-2-3	Cam spindle nut, retaining indicator	1	3
3716-52	G-25-2	Quadrant and drive peg for control spindle	1	7 9
3718-52	G-24-2	Quadrant spindle	1	12 6
3720-52	20-3-1	Quadrant spindle bush (inner)	1	1 6
3723-52	20-8-9	Quadrant spindle bush (outer)	1	2 6
3725-52	12-5-2	Quadrant spindle cover washer	1	1
3728-52	36-11-1	Main return spring for control quadrant	1	2 0
3733-52	G-29-2	Selector fork	2	10 0
3736-52	G-30-2	Selector fork spindle	2	7 6
3738-52	12-7-4	Selector spindle cover washer	2	3
3739-52	35-3-1	Selector spindle peg	4	6
3741-52	16-1-4	Selector spindle cotter pin	4	1
3743-52	27-7-4	Selector spindle oil seal	1	4
3746-52	36-8-3	Return spring (secondary) (coil)	1	6
3751-54	E9/3251	Foot change lever	1	11 3
3514-33	10-2-2	Foot change lever bolt	1	1 10
3516-33	11-2-1	Foot change lever bolt nut	1	3
3752-52	12-2-1	Foot change lever bolt nut washer	1	1

EXPLODED VIEW OF CLUTCH (GB GEARBOX)

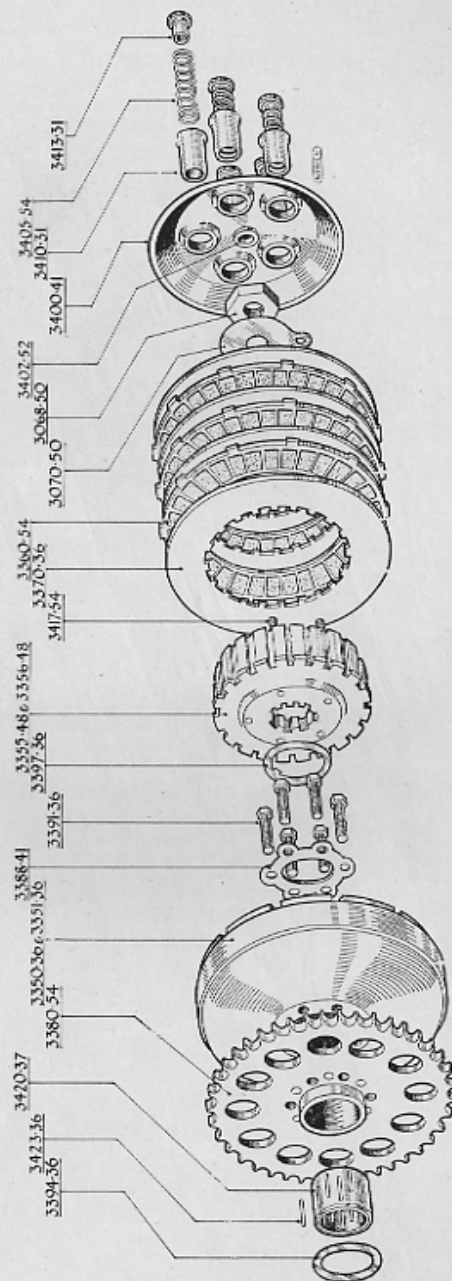

FRONT FORK ASSEMBLY

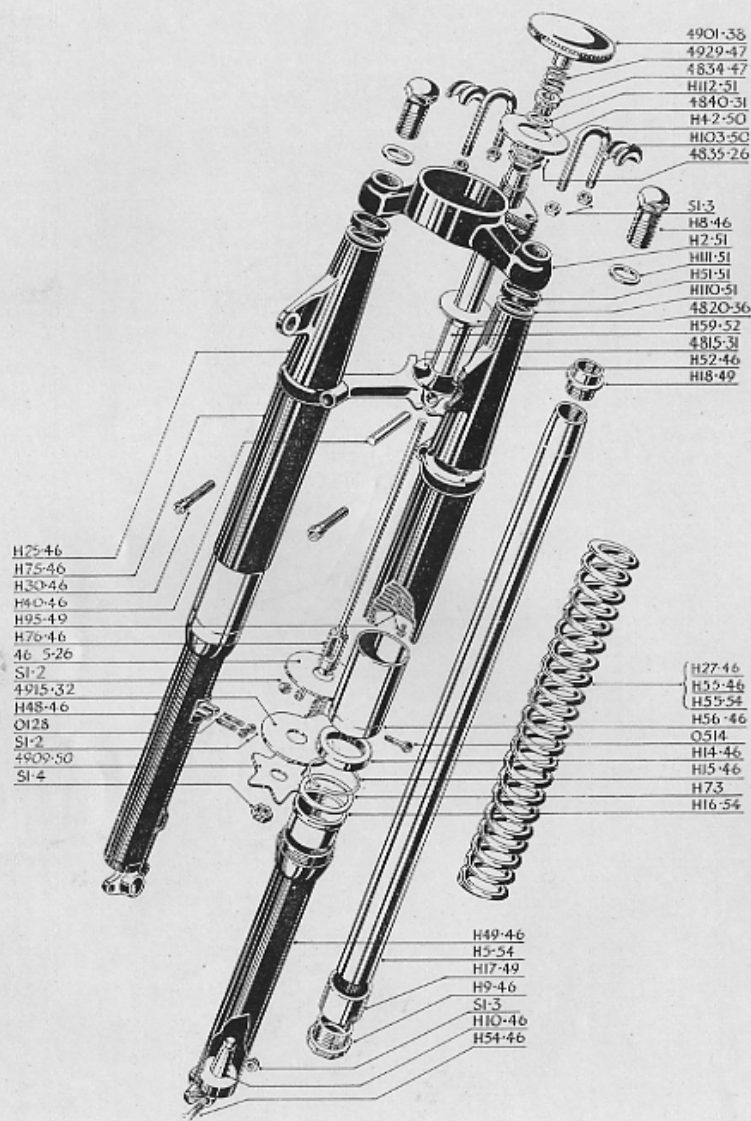

Order by SPARES No.	Do not use PART No.	DESCRIPTION OF PART	No. per Set	PRICE EACH £ s. d.
3508-33	G-48-1	Foot change lever rubber	1 ..	1 1
3756-52	G-47-1	Foot change indicator	1 ..	9
3758-52	27-4-2	Foot change indicator oil seal	1 ..	3
3760-52	20-4-2	Cam spindle bush (outer)	1 ..	2 0
3763-52	36-4-1	Indicator oil seal spring	1 ..	3
3766-52	G-35-5	Mainshaft sleeve	1 ..	17 0
3770-52C	G-33-2C	Clutch operating lever	1 ..	5 6
3783-52	11-3-2	Clutch operating lever adjusting sleeve	1 ..	9
3785-52	32-7-1	Adjusting sleeve cap	1 ..	2 3
3788-52	14-2-9	Adjusting sleeve cap screw	2 ..	9
3790-52	G-54-2	Clutch operating plunger	1 ..	9
3794-52	17-3-2	Clutch operating plunger ball, $\frac{3}{8}$ in.	1 ..	1
3792-52	E9.644A	Clutch cable adjuster	1 ..	1 9
3793-52	E9.645	Locknut for cable adjuster	1 ..	7

CLUTCH PARTS—GB33 GEARBOX

3350-36	G-36-9	Clutch case (three-plate)	1 ..	19 6
3355-48	G-37-8	Clutch centre (three-plate)	1 ..	1 8 6
3360-54	G-40-13	Clutch plate, fitted Klingerite inserts	3 ..	15 0
3365-54	G-41-6	Clutch plate inserts (Klingerite) .. per dozen	3 6	
3370-36	G-39-5	Clutch plain plate	4 ..	3 9
3380-54	G-34-12	Chain wheel ($\frac{1}{2}$ in. \times .305 in. \times 42T)	1 ..	1 19 0
3388-41	12-12-6	Chain wheel set pin lock washer	1 ..	4
3391-36	10-2-4	Chain wheel set pin	6 ..	4
3394-36	12-11-7	Thrust washer (inner)	1 ..	1 1
3397-36	12-11-8	Thrust washer (outer), keyed	1 ..	1 1
3400-41	G-38-3	Clutch spring plate	1 ..	11 3
3402-52	40-7-2	Clutch spring plate thrust cup	1 ..	6
3405-54	G-36-61	Clutch spring (for Klingerite inserts)	5 ..	6
3410-31	G-42-2	Clutch spring cup	5 ..	9
3413-31	11-2-2	Clutch spring adjusting nut	5 ..	6
3417-54	13-2-11	Clutch spring stud	5 ..	6
3420-37	G-53-1	Roller cage	1 ..	2 7
3423-36	18-1-1	Needle rollers per set of 12	2 3	
3430-52	37-3-6	Clutch operating rod	1 ..	1 6

FRONT FORK ASSEMBLY AND FITTINGS

Tele-54		Front fork assembly complete	1 ..	18 12 6
H2-51	H/107	Handlebar bracket	1 ..	1 5 0
H5-54	H/186	Fork shaft	2 ..	1 16 9
H8-46	H/8	Fork shaft head nut	2 ..	3 0
H9-46	H/9	Plug (fork shaft, bottom)	2 ..	1 4
H10-46	H/10	Oil regulator plunger	2 ..	2 0
H14-46	H/14	Oil seal	2 ..	3 0
H15-46	H/15	Circlip	2 ..	4
H16-54	H/187	Top bearing	2 ..	8 0
H17-49	H/17A	Lower bearing	2 ..	9 3
H18-49	H/90	Plug for fork shaft (top)	2 ..	3 0
H25-46	H/25	Top cover and headlamp bracket, R/S	1 ..	13 3
H52-46	H/52	Top cover and headlamp bracket, L/S	1 ..	13 3
H51-51	H/108	Rubber washer	2 ..	4
H27-46	H/27	Spring (solo), yellow spot, overall length $10\frac{1}{2}$ in. to $10\frac{1}{2}$ in.	2 ..	4 10
H55-46	H/55	Spring (sidecar), red spot, overall length $9\frac{1}{2}$ in. to $9\frac{1}{2}$ in.	2 ..	6 2
H55-54	89/5036	Spring (heavy duty), sidecar	2 ..	7 0
H30-46	H/30	Bolt for crown	2 ..	1 0
H40-46	H/40	Fork crown pin	1 ..	6

EXPLODED VIEW OF FRONT WHEEL HUB ASSEMBLY

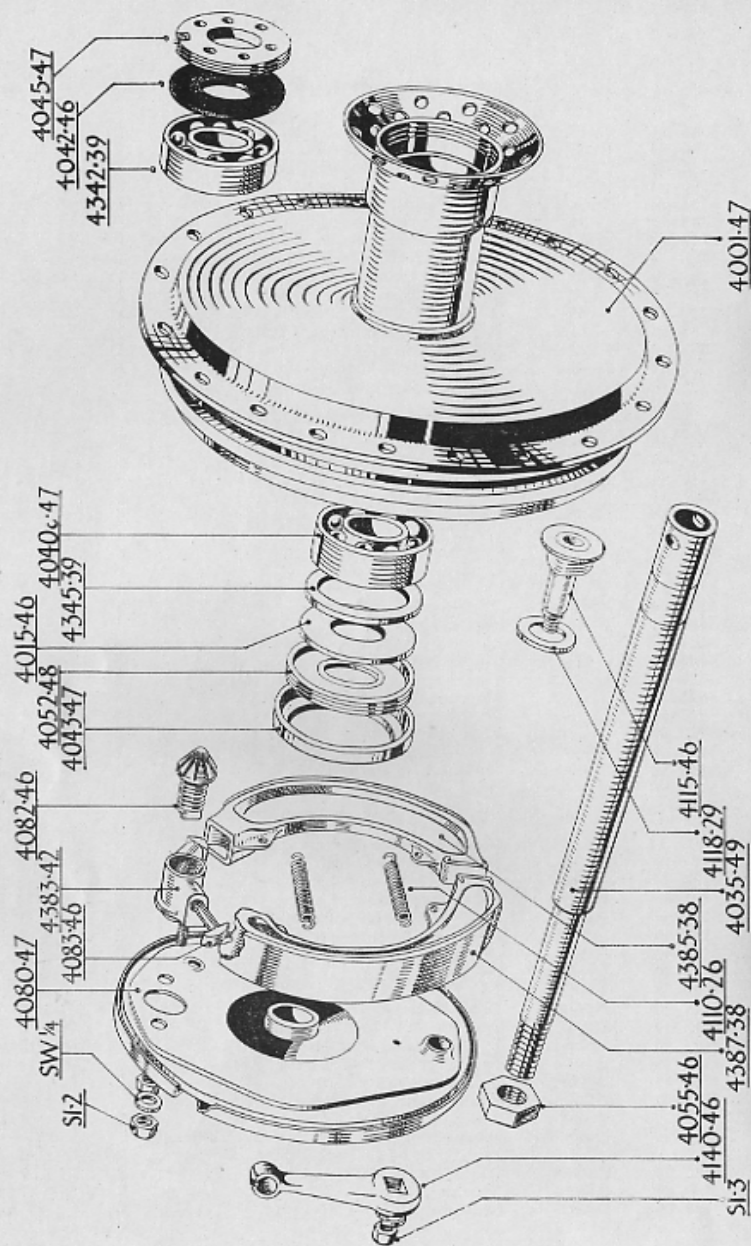

Order by SPARES No.	Do not use PART No.	DESCRIPTION OF PART	No. per Set	PRICE EACH £ s d.
H42-50	H/42A	Handlebar shackle	2	3 0 0
H49-46	H/49	Sliding tube assembly, L/S	1	2 17 0
H48-46	H/48	Sliding tube assembly, R/S	1	2 18 9
H59-52	H/91A	Steering column complete	1	3 1 3
H75-46	H/75	Bottom cover and plate assembly	2	8 9
H76-46	H/76	Damper bolt assembly	1	5 0
081	E8/492	Screw for bottom cover plate	6	2
H54-46	H/54	Bolt for fork end	1	7
S1-3		Nut for fork end bolt	1	2
S19-3		Washer for fork end bolt	1	1
S1-3		Nut for handlebar shackle	4	2
S19-3		Washer for handlebar shackle	4	1
H56-46	H/56	Oil seal holder complete	2	9 6
0128	A6/84	Stud for centre stay	4	5
H73A		Shim (top bearing and circlip), .010 in. as reqd.	-	3
H73B		Shim (top bearing and circlip), .020 in. as reqd.	-	3
H73C		Shim (top bearing and circlip), .030 in. as reqd.	-	4
H110-51		Washer for H51 (steel)	2	5
H111-51		Washer for fork shaft head nut	2	5
H112-51		Washer for steering column (top)	1	5
H113-51		Washer for steering column (bottom)	1	5
H113-53	29/5338	Washer for lower bearing	2	4
0590	E8/548	Bolt for headlamp fixing	2	9
H93-49	H/93	Distance piece for headlamp fixing	2	5
H103-50	H/103	Liner for handlebar shackle	2	2 0
4749-53	C20/26A	Brake stop lug	1	1 4
4167-47	C20/22	Cable adjuster (front brake)	1	1 2
4168-47	C20/23	Adjuster locknut	1	6
N4S		Nut for brake stop lug	1	3

STEERING HEAD FITTINGS

4815-31	D10/3	Steering crown ball race	1	4 4
4818-31	D10/2	Head clip ball race	1	4 4
4820-36	D10/137	Outer race (head lug)	2	4 4
S9-2		1/2 in. diameter steel balls	per set of 40	2 2
4834-52	H/41A	Steering column plug	1	2 7
4835-26	D8/21	Nut for steering column	2	1 4
4838-31	D10/7	Felt washer	2	7
4840-31	D10/8	Dust cover	1	5
4901-38	D10/141	Steering damper knob	1	6 0
4905-26	D9/19	Locknut (damper)	1	4
4909-50	D10/136A	Star washer	1	10
4915-32	E9/157	Anchor plate	1	4 4
4929-47	D10/276	Spring for damper knob	1	6
4665-26	D8/26	Friction disc	1	1 2
0514	E8/390	Bolt for anchor plate	1	7
S1-2		Nut for 0514 bolt	1	2
P6		Grease nipple for head lug	2	5

FRONT WHEEL ASSEMBLY AND FITTINGS

4000-51D		Front wheel complete, bearings, spindle and brake parts, less tyre (please state finish required)	1	9 8 0
4001-47	C20/35	Hub and brake drum assembly	1	2 12 6
4002-47D	C20/35	Hub, rim and spokes only, built up	1	5 5 0

FIXED REAR WHEEL AND HUB ASSEMBLY

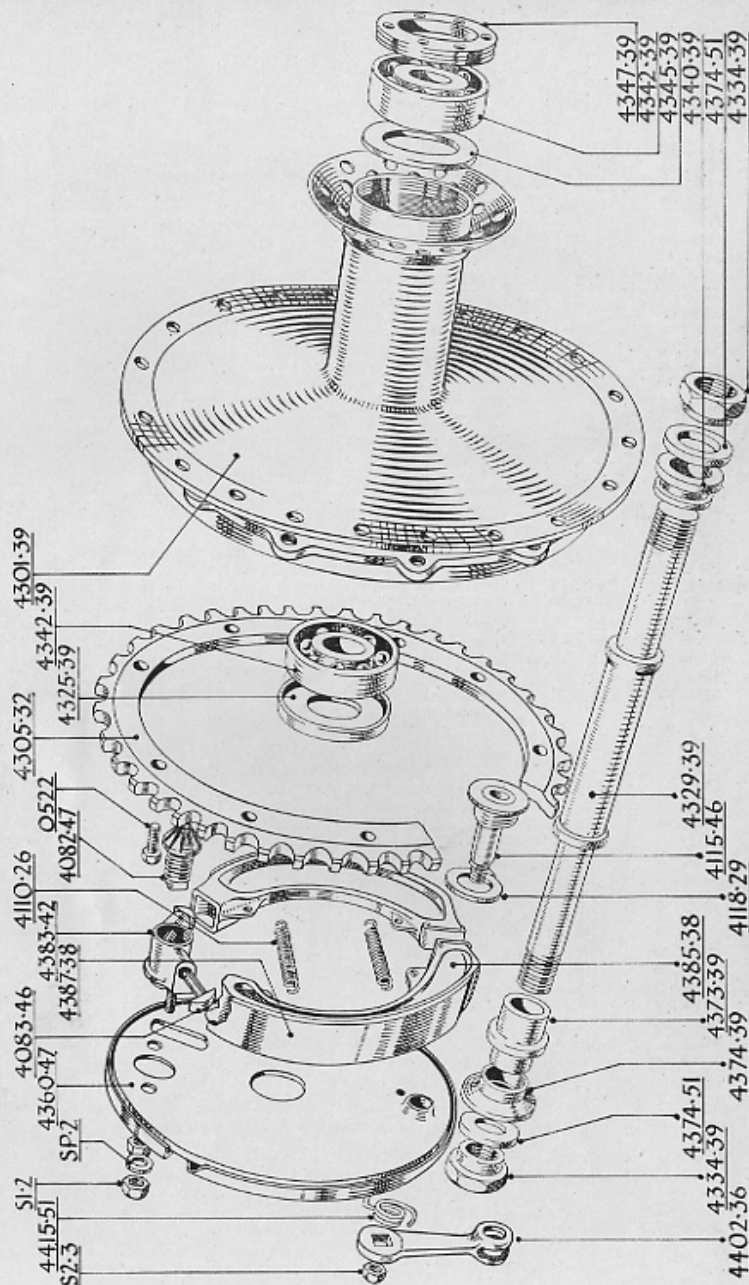

22

Order by SPARES No.	Do not use PART No.	DESCRIPTION OF PART	No. per Set	PRICE EACH £ s. d.
4015-46	C20/24	Oil retaining washer, R/S ..	1	6
4035-49	C20/45	Hub spindle ..	1	7 9
4040C-47	C20/38	Ball bearing with sleeve, R/S ..	1	16 9
4342-39	MS/8	Ball bearing, L/S ..	1	15 0
4042-46	C20/25	Oil retaining washer, L/S ..	1	6
4043-47	C20/20	Locking ring cover ..	1	7
4045-47	C20/6	Locking ring, L/S ..	1	3 0
4052-48	C20/18	Locking ring, R/S ..	1	3 0
4055-46	C20/17	Hub spindle nut ..	1	1 0
4080-47	C20/37	Brake plate c/w fixed fittings ..	1	13 0
4082-46	C20/32	Brake wedge ..	1	3 6
4083-46	C20/31	Wedge spindle ..	2	1 9
4108-26	C13/24	Rivet for brake lining ..	per set of 12	6
4110-26	C13/5	Spring for brake shoes ..	2	5
4115-46	C20/11	Brake cam ..	1	4 4
4118-29	C13/66	Washer for brake cam ..	2	2
4140-46	C20/13	Brake lever ..	1	5 6
4379-34	A7/453	Nut securing wedge holder ..	2	9
4383-42	C15/23B	Brake wedge holder ..	1	4 4
4385-38	C15/97	Brake shoe c/w lining ..	2	12 10
4387-38	C15/104	Brake shoe lining c/w rivets ..	per pair	15 4
0625	C20/29	Bolt for brake anchorage ..	1	7
S1-3		Nut for brake lever ..	1	2
WM1-20		Rim only, 40-hole (3.00 in. x 20 in.), state finish required ..	1	1 11 0
4530-47		Spoke nipples only for 10G spokes ..	40	2
4535-51		Set of spokes and nipples for WM1-20 rim ..	per set of 40	13 6
4531-51	C20/50	Spoke, R/S, c/w nipple (7 in. x 10G x 80°) ..	20	5
4537-51	C20/48	Spoke, L/S, c/w nipple (9½ in. x 10G x 135°) ..	20	5

FIXED REAR WHEEL AND HUB

4301C-54		Wheel c/w bearings, spindle, brake parts and sprocket, less tyre (state rim size and finish required) ..	1	12 0 0
4301-48	C15/129AC	Hub, brake drum and spoke flange only ..	1	2 16 0
4303-48		Hub assembly 4301-48 with rim and spokes, built up (state finish and rim size required) ..	1	5 1 0
4305-32	C15/22	Chain sprocket, 47T ..	1	1 10 6
0522	C13/84	Chain sprocket bolt ..	10	7
4325-39	C15/122	Grease retainer (pressed in hub, outside bearing) ..	1	6
4329-54	C15/230	Wheel spindle ..	1	12 0
4334-39	DW/41	Wheel spindle nut ..	2	1 4
4340-39	C15/123	Fork end distance piece, R/S ..	1	1 9
4342-39	MS/8	Ball bearing ..	2	15 0
4345-39	C15/128	Ball bearing abutment washer inside hub tube, R/S ..	1	5
4347-39	DW/7	Ball bearing locking nut, R/S ..	1	1 9
4360-54	C15/228	Brake plate ..	1	16 6
4373-54	C15/232	Brake plate distance piece (inside plate) ..	1	10
4374-54	C15/234	Brake plate distance piece (outside plate) ..	1	8
4374-54	C15/234	Distance piece (next to wheel spindle nut) ..	2	8
4375-54	E9/3223	Brake plate anchor bar ..	1	4 4
0714	ES/781	Bolt securing anchor bar to frame ..	1	7
		½ in. dia. shakeproof washer ..	1	2
4376-54	E9/3262	Cable abutment (brake plate) ..	1	1 3
S2-3		Locknut for cable abutment ..	1	2
		Shakeproof washer for locknut ..	1	2

23

DETACHABLE REAR WHEEL HUB ASSEMBLY

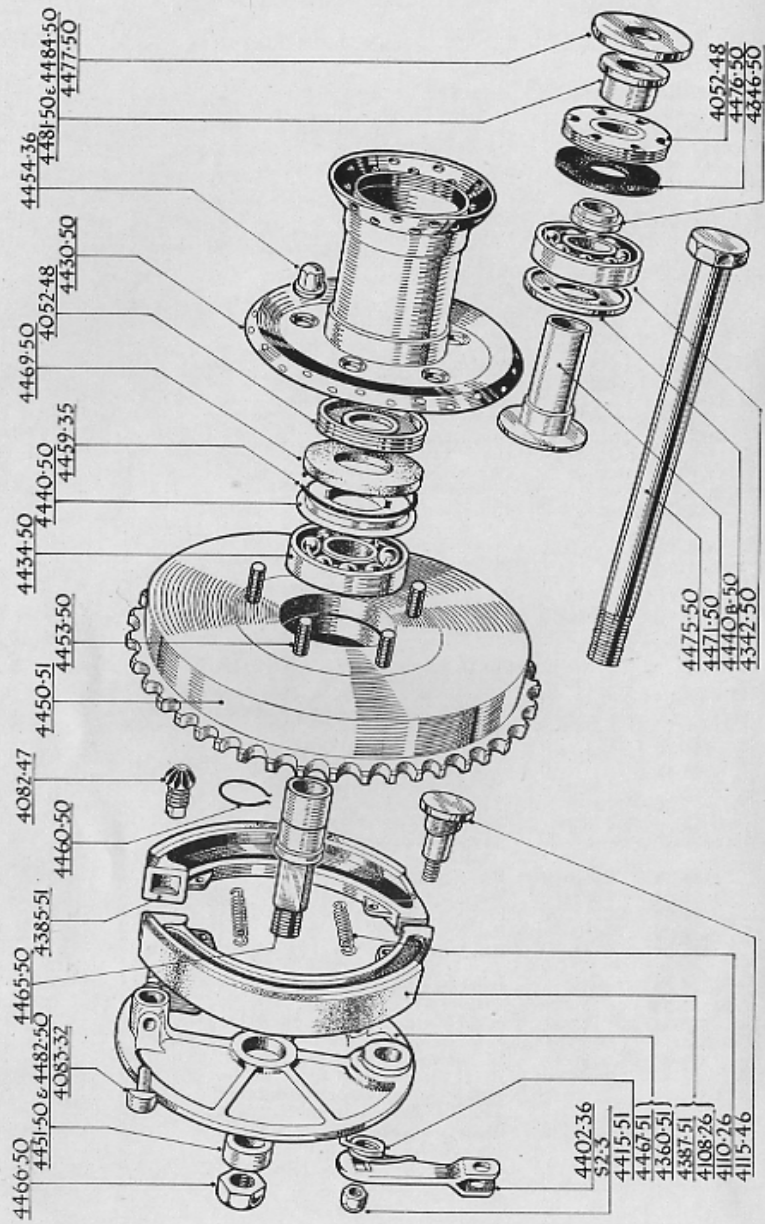

Order by SPARES No.	Do not use PART No.	DESCRIPTION OF PART	No. per Set	PRICE EACH £ s. d.
4082-47	DW/91	Brake fulcrum adjusting wedge (screws in plate)	1	3 6
4083-46	C20/31	Brake fulcrum spindle	2	1 9
4108-26	C13/24	Brake lining rivets	per set of 12	6
4110-26	C13/5	Brake shoe return spring	2	5
4115-46	C20/11	Brake cam	1	4 4
4118-29	C13/66	Brake cam washer	2	2
4383-42	C15/23B	Brake wedge holder	1	4 4
S1-2		Nut securing holder	2	2
SP-2		1/4 in. dia. shakeproof washer	2	1
4385-38	C15/97	Brake shoe half c/w lining	2	12 10
4387-38	C15/104	Brake lining (6 1/2 in. x 1 1/2 in. x 1/8 in.) c/w rivets	per pair	15 4
4402-54	E9/3261	Brake cam lever	1	4 4
4415-53	E9/1479	Brake cam lever return spring	1	6
S2-3		Nut for brake lever	1	2
S5-3		Spring washer	1	2
WM2-19		Rim, 40-hole (state colour required)	1	1 11 0
4519-35		Nipple for 10G spoke	40	2
4545-39		Set of spokes and nipples for WM2-19 rim	40	13 6
4546-51	C15/220	Spoke for WM2-19 rim (brake side), 6 1/2 in. x 8-10G, butted 90°, c/w nipple	20	5
4549-51	C15/223	Spoke for WM2-19 rim (flange side), 9 1/2 in. x 10G, 135°, c/w nipple	20	5
DETACHABLE REAR WHEEL				
4429-54C		Detachable rear wheel c/w brake parts, spindle, bearings, brake drum, etc., and all fittings, less tyre. (Deep claret and chrome finish). (State rim size required)	1	13 10 0
4429-51		Detachable wheel only, comprising hub, bearing, locking ring and grease retainer, etc., rim and spokes built up. (Deep claret and chrome finish). (State rim size required)	1	5 1 0
4082-47	DW/91	Brake fulcrum adjusting wedge (screws in brake plate)	1	3 6
4083-32	C15/24	Wedge spindle	2	2 0
4052-48	C20/18	Locking ring	2	3 0
4108-26	C13/24	Brake lining rivets	per set of 16	6
4110-26	C13/5	Brake shoe return spring	2	5
4115-46	C20/11	Brake cam	1	4 4
4118-29	C13/66	Brake cam washer	1	2
4342-50		Ball bearing for hub, R/S (3/4 in. x 2 in. x 3/8 in.)	1	15 0
4346-50	DW/104	Collar for ball race, R/S	1	9
4375-54	E9/3223	Brake plate anchor bar	1	4 4
0716	E8/547	Bolt securing brake plate to anchor bar	1	7
S1-4		Nut for 0716	1	4
0714		1/2 in. dia. shakeproof washer	1	1
0714	E8/781	Bolt securing anchor bar to frame	1	7
4376-54	E9/3262	Cable abutment (brake plate)	1	1 3
S2-3		Locknut for cable abutment	1	2
		Shakeproof washer for locknut	1	2
4385-51	C15/213	Brake shoe half c/w lining	2	15 2
4387-51	C15/216	Brake lining c/w rivets	per pair	18 6
4402-54	E9/3261	Brake cam lever	1	4 4
4415-53	E9/1479	Spring for brake lever	1	6
4430-50	DW/116	Hub assembly only, less brake drum	1	1 16 0

Order by SPARES No.	Do not use PART No.	DESCRIPTION OF PART	No. per Set	PRICE EACH		
				£	s.	d.
4434-50		Ball bearing, L/S (1 in. x 2 1/4 in. x 1/2 in.)	1	16	2	
4440-50	DW/100	Grease retainer (large)	1			6
4440B-50	DW/101	Grease retainer (small)	1			9
4450-51	C15/211	Brake drum and chain wheel c/w studs	1	2	16	0
4453-50	C15/93A	Brake drum drive stud	5			10
4454-36	C15/92	Brake drum drive stud nut	5			2 6
4459-35	A7/500	Circlip (large), brake drum side	1			6
4460-50	DW/103	Circlip for fixed spindle	1			3
4465-53	DW/102A	Fixed spindle (3/4 in. x 20T)	1	10		0
4466-54	DW/123	Fixed spindle locknut (3/4 in. x 20T)	1			1 0
4467-54	DW/124C	Brake plate c/w fixed fittings	1	16		6
4469-50	DW/108	Grease retaining washer (cork)	1			6
4471-50	DW/96C	Distance tube and retaining sleeve in hub	1			2 6
4475-54	DW/122	Spindle bolt (3/4 in. x 20T)	1	8		6
4476-50	DW/112	Grease retaining washer (rubber), next locking ring	1			4
4477-50	DW/106	Washer for fixed spindle and spindle bolt 3/4 in. dia. shakeproof washer for fixed spindle and spindle bolt	2			1 0
4481-50	DW/105	Butted slip collar, R/S	1			2 6
WM2-19		Rim (3.5 in. x 19 in.), 40-hole (finish: deep claret and chrome)	1	1	11	0
4546-50	DW/117	Spokes (brake side), 7 in. x 8-10G, butted 135°, c/w nipples	20			5
4547-50	DW/118	Spokes (flange side), 8 1/2 in. x 10G, 135°, c/w nipples	20			5
4548-50	DW/117/8	Set of spokes and nipples for detachable rear wheel	40			13 6
003		Angle grease nipple (1/4 in. x 26 T.P.I.)	1			10

FRONT MUDGUARD AND STAND FITTINGS

4702-51	H/120	Mudguard, plain, c/w centre fixing bracket	1	1	7	6
4711-51	H/122	Mudguard stay, plain	2			3 0
4730-47	H/47	Front stand	1			13 0
4733-26	D9/34	Bolt for stand	2			7
4741-28	D9/101	Nut for locking stand	1			7
4743-53	H/137	Moulding for front number plate	1			6
4745-53	H/129	Front number plate	1	6		0
4746-52	H/128	Front brake cable clip	1			5
S1-2		Nut for number plate	2			2
S1-3		Nut for front stand bolt	2			2
S6-3		Thackery washer	2			2
S19-2		Washer for number plate	2			2
098	K/365	Cable clip screw	1			3
S1-1		Nut for clip screw	1			1
0510	E1/60	Bolt for mudguard stay	3			7
0564	D9/102	Bolt for locking stand	1			7

FRAME (DUPLIX GRADLE TYPE) AND FITTINGS

4953-54C	E9/3125C	Frame c/w rear pivoted fork suspension and damper units	1	33	7	9
4953-54	E9/3125	Frame only, less pivoted forks and damper units	1	23	0	0
4963-54	E9/3059	Pivoted fork c/w distance tube and bushes	1	3	11	0
4972-54	E9/3050	Spindle for pivoted rear fork	1			5 0
4991-54	E9/3086	Distance tube for spindle	1			1 8

FRAME AND PIVOTED REAR FORK SUSPENSION UNITS

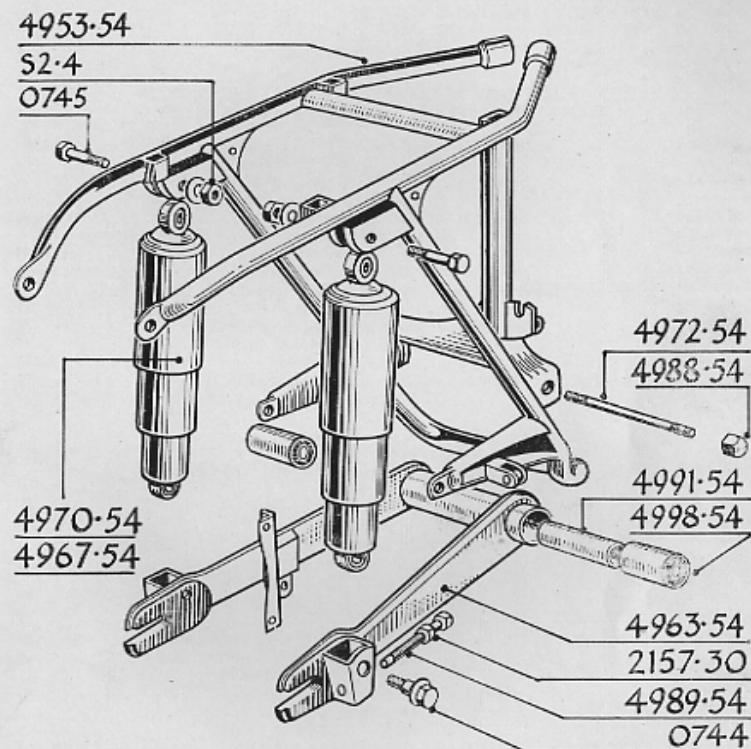

Order by SPARES No.	Do not use PART No.	DESCRIPTION OF PART	No. per Set	PRICE EACH £ s. d.
4998-54	E9/3244	Bush for pivoted fork (metalastic)	2	5 6
4988-54	E9/3052	Domed nut for pivot fork spindle	2	1 9
0744	E9/3070	Bolt (short), bottom fixing, damper unit	2	6
0745	E9/3069	Bolt (long), top fixing, damper unit	2	7
S2-4		Locknut	2	4
		Shakeproof washer for bolt fixing damper unit	4	2
0546	E9/3228	Bolt for brake pedal stop	1	4
4989-54	E9/3043	Rear wheel adjusting bolt	2	10
2157-30	E8/234	Rear wheel adjusting bolt locknut	2	2
4997-54	E9/3264	Plate for stop light switch	1	1 0

REAR PIVOTED FORK SUSPENSION UNIT

4967-54A		Suspension unit complete AT7/1180A (solo) (Series A)	2	3 5 0
4967-54B		Suspension unit complete AT7/1180A (solo) (Series B)	2	3 5 0
4970-54		Suspension unit complete AT7/1261A (s/car)	2	3 5 0
4976-54		Cover (outer) AT7/541	2	5 10
4977-54		Cover (inner) AT7/542	2	8 3
4978-54A		Spring (solo) AT7/577 (Series A)	2	8 7
4978-54B		Spring (solo) AT7/737 (Series B)	2	8 7
4979-54		Spring (s/car) AT7/708	2	8 7
4981-54A		Mounting rubbers AT7/425 (Series A)	4	9
4981-54B		Mounting rubbers AT6/450 (Series B)	4	7
4983-54		Top spring abutment AT7/543	2	1 5
4987-54B		Mounting rubber steel insert (Series B)	4	5

PETROL TANK AND FITTINGS

5001-54	E9/3188	Petrol tank only (capacity 4 galls.) (Finished deep claret and chrome)	1	9 10 0
5001A-54	E9/3188C	Petrol tank as above c/w fittings	1	11 12 0
5004-54	E9/3299	Ariel badge for petrol tank	2	7 6
050	E9/1521	Screw for Ariel badge	4	1
5012C-30	E8/995C	Petrol filler cap complete	1	7 0
5012-30	E8/995	Petrol filler cap only, with anti-splash and washer	1	3 8
5020-30	E8/1090C	Petrol filler cap screw	1	2 7
5023-29	E8/632	Petrol filler cap screw leather washer (7/8 in. O.D.)	1	4
5023-30	E8/991	Petrol filler cap screw leather washer (7/8 in. O.D.)	1	4
5025-29	E8/629	Petrol filler cap washer	1	7
5027-30	E8/986	Petrol filler cap locking cam	1	1 4
5028-30	E8/992	Petrol filler cap locking cam locknut	2	2
5050-50		Petrol tap and strainer	1	9 0
5054-27	E8/403	Petrol tap washer	2	5
5057-54	E9/3307	Distance tube for tank fixing bolt	4	6
0579	E9/462	Tank fixing bolt (3/8 in. x 1 1/8 in. x 18 T.P.I.)	4	10
5058-26	E8/68	Tank fixing bolt steel washer	4	5
5060-27	E8/247	Tank fixing bolt rubber washer (3/8 in. thick)	4	7
5060-31	E9/166	Tank fixing bolt rubber washer (3/8 in. thick)	4	5
5069-51		Petrol pipe complete (flexible)	1	8 0
5082-53	E9/1496	Knee grip, R/S	1	5 6
5083-53	E9/1497	Knee grip, L/S	1	5 6
5088-54	E9/1501	Knee grip plate securing bolt	4	2

Order by SPARES No.	Do not use PART No.	DESCRIPTION OF PART	No. per Set	PRICE EACH £ s. d.
SPEEDOMETER				
Makers: Messrs. S. SMITH (MA) LTD., Cricklewood, London				
5202-50		Speedometer head, 180 k.p.h.	1	3 10 0
5203-50		Speedometer head, 120 m.p.h.	1	3 10 0
5213-51	H/109	Strap for speedometer head	1	1 0
5226-52		Speedometer cable complete (3 ft. 7 in. long)	1	1 2 6
5231-52		Speedometer cable, inner flex only	1	11 3
5236-52		Speedometer cable, outer flex only	1	11 3

FOOTREST, BRAKE PEDAL AND CABLE

5377-54	E9/3049	Tie bolt for footrest	1	2 0
5383-54	E9/3064	Footrest, R/S	1	6 0
5384-54	E9/3065	Footrest, L/S	1	6 0
5385-54	E9/3048	Distance tube for tie bolt	1	1 0
5390-54	E9/3053	Sleeve nut for footrest	2	10
5392-52	E9/1378	Rubber pad for footrest	2	2 6
5400-54	E9/3062	Brake pedal	1	15 0
5412-51	E9/580A	Brake pedal spindle	1	4 0
5428-54	E9/3263	Brake cable c/w cover and jaw joint	1	6 0
5439-54	65/9228	Clip complete, securing spring for stop light switch to brake cable	1	5
5736-54		Spring for stop light switch (4 in. long)	1	1 6
S48-2		Brake cable jaw joint swivel pin	1	5
5434-53	E9/1472	Brake cable adjuster	1	1 6
5435-53	E9/645A	Locknut for cable adjuster	1	7
S17-1		Split cotter pin for S48-2	1	1

PILLION FOOTRESTS

5541-32	E9/345	Footrest rubber pad	2	2 6
5542-28	E8/420	Footrest only	2	4 10
5547-28	E8/423	Thackeray washer	2	3
07	E8/756	Screw for footrest	2	7
S2-4		Locknut	2	4

REAR MUDGUARD

5580-54	E9/3073	Rear mudguard complete	1	1 10 0
0207	E9/3147A	Bolt securing tail guard to frame	3	4
5647-53	E9/1506	Rear number plate	1	8 6
5650-53	E9/1509	Rubber moulding for rear number plate	1	1 0
S1-2		Nut securing number plate to mudguard	2	2
5669-54		Reflector (P90)	1	2 6
5004-34	E9/487	Ariel nameplate	1	5 0
042	E9/609	Screw and nut for nameplate	2	3

CHAINS AND CHAIN COVERS

5702-54	E9/3032	Clutch dome	1	10 6
041	E9/610	Clutch dome cheese-head screw (1/2 in. x 3/8 in. x 20 T.P.I.)	3	4
5710-54	E9/3001	Oil bath chain case (outer half)	1	1 14 0
5712-54	K/382	Oil bath chain case (back half)	1	1 14 0
03	A7/121	Screw for inner cover	1	7

Order by SPARES No.	Do not use PART No.	DESCRIPTION OF PART	No. per Set	PRICE EACH £ s. d.
014	A8/33	Screw, inner cover to engine	3	7
015	A8/34	Oil bath cheese-head screw	9	7
017	E10/68	Clutch cover screw (long)	1	7
5720-54	E9/3033	Upper rear chain guard	1	13 0
0524	ET/578	Front bolt for fixing upper chain guard ..	1	6
0566	E4/75	Rear bolt for fixing upper chain guard ..	1	7
0510	E1/60	Bolt for fixing front of lower chain guard	1	7
0513	E8/294	Bolt for fixing rear of lower chain guard..	1	5
5722-54	E9/3034	Lower rear chain guard	1	7 6
5730-54	E9/3264	Plate for stop light switch box	1	1 0
5736-54		Spring for stop light switch (4 in. long) ..	1	1 6
5750A-32	E9/298A	Inspection plug	1	4 4
5751-31	E8/514	Inspection plug washer	1	6
5760-54	E9/3044	Washer (paper) between two halves of chain case	1	1 4
5767-39	E9/775	Chain case "oil level" plug	1	6
5768-37	A6/769	Chain case "oil level" plug washer	1	3
5770-31	E9/64	Adjusting screw for rear chain lubrication	1	9
5772-31	E9/65	Adjusting screw spring	1	3
041	E9/610	Drain screw for chain case	1	4
5751-54	E9/1519	Washer for drain screw	1	1
5780-33		Front chain (1/8 in. x .305 in. x 73 pitches)	1	5 10
5782-28		Front chain (1/8 in. x .305 in. x 72 pitches)	1	5 10
5790-54		Rear chain (1/8 in. x 1/2 in. x 100 pitches) ..	2	6 11

OIL TANK AND FITTINGS

5850-54	E9/3086	Oil tank	1	2 3 9
5854-29	E8/503	Filler cap and dome with washer	1	2 7
5855-29	E8/514	Filler cap washer	1	6
0182	E8/762	Fixing stud for air cleaner and battery carrier	1	5
5860-51	E9/409A	Nut for 0182 stud	2	1 0
0513	E8/294	Bolt for fixing oil tank	2	5
S19-2		Washer for bolt	2	2
S1-2		Nut for 0513	2	2
0582	E9/3210	Steady bolt for oil tank	1	5
5861-52	E9/1377	Oil filter gauze and spring	1	4 4
5882-54		Oil pipe, nipple and nut (delivery)	1	5 0
5885-54		Oil pipe, nipple and nut (return)	1	5 0
5892-52	K/363A	Rubber "T" connection for oil pipe	1	1 6
5896-29	E8/775	Rubber connection (1/8 in. bore)	1	6
5897-31		Clip for connection (1/8 in. bore), plain ..	4	2
5898-30	E8/1150	Drain plug	1	10
5899-30	A6/646	Drain plug washer	1	2

EXHAUST PIPES AND SILENCERS

6017-54	E9/3235A	Exhaust pipe, R/S	1	1 12 0
6018-54	E9/3236A	Exhaust pipe, L/S	1	1 12 0
6037-54	E9/3267	Silencer, R/S	1	2 3 9
6038-54	E9/3268	Silencer, L/S	1	2 3 9
6061-33	A7/354	Exhaust pipe clip complete for head joint	2	5 3
6063-29	E8/529	Clip complete (pipe to silencer joint) ..	2	2 6
0540	A7/560	Set screw for finned clip	2	7
0311	E9/3225	Bolt for fixing silencer to frame	2	5
S19-4		Washer for bolt	2	2
S1-4		Nut for bolt	2	4

Order by SPARES No.	Do not use PART No.	DESCRIPTION OF PART	No. per Set	PRICE EACH £ s. d.
BATTERY CARRIER				
6107-51	E9/1294	Top strap securing accumulator	1	4 0
6108-51	E9/1295	Lower strap securing accumulator	1	3 9
6109-43	E8/1024	Swivel pin (short) for top battery strap ..	1	1 0
6109-51	E9/1297	Swivel pin (plain hole) for battery strap ..	1	1 0
6109A-51	E9/1298	Swivel pin (tapped hole) for bottom battery strap	1	1 0
0544	E9/1296	Pin for battery strap	2	7
S51-1	E9/1299	Hinge pin for battery strap	1	4
		Split pin for S51-1	1	1
6151-54	E9/3058	Battery platform	1	9 6
6154-54	K/341	Screw for fixing battery platform to chain case	2	7
0516	D9/148	Set bolt for voltage control	2	5
DUAL SEAT				
6223-54	E9/3079	Dual seat complete	1	4 12 6
0209	E9/3206	Bolt for dual seat	1	7
S19-3		Washer	4	2
0210	E9/3211	Stud for dual seat fixing	2	7
S1-3		Nut	3	2

HANDLEBARS AND CONTROLS

6400-46	H/63	Handlebar	1	1 6 3
6415-48		Clutch control lever assembly complete (Amal)	1	13 6
6415B-48		Clutch lever only (Amal)	1	5 9
6416B-38		Front brake lever only (Amal)	1	5 9
6416C-48		Lever fulcrum pin (Amal)	2	3
6416D-48		Fulcrum pin nut (Amal)	2	3
6416G-48		Clamp screw (Amal)	4	3
6421-48		Front brake control lever assembly complete (Amal)	1	13 6
6421A-48		Brake control bracket (Amal)	1	5 9
6421B-48		Clutch control bracket (Amal)	1	5 9
6421D-48		Brake bracket clamp (Amal)	1	10
6421F-48		Clutch bracket clamp (Amal)	1	10
6425-50		5 in. twist grip assembly complete (Amal)	1	14 1
6425Q-50		5 in. dummy grip (Amal)	1	1 6
6430E-39		5 in. twist grip rubber	1	1 0

HANDLEBAR CONTROL CABLES

6460-52		Clutch cable complete	1	5 6
6480-46	C20/39	Front brake cable complete	1	5 3
6495-50		Throttle cable complete	1	5 3

TOOL BOX AND TOOL KIT

6555-54C	E9/3085	Tool box and lid c/w fittings	1	1 2 0
6600-36	G1/125	Double-ended spanner (1/8 in. x 1/4 in. bolts)	1	1 6
6600-32	G1/110	Spanner for brake fulcrum adjustment ..	1	1 4
6603-28	G1/89	Double-ended spanner (1/8 in. x 3/8 in. bolts)	1	2 7
6604-28	G1/60	Double-ended spanner (1/8 in. x 5/8 in. bolts)	1	1 4
6604-36	G1/124	Double-ended spanner (1/8 in. x 3/8 in. bolts)	1	1 4
6605-28	G1/86	Double-ended spanner (1/8 in. x 1/4 in. bolts)	1	3 0

Order by SPARES No.	Do not use PART No.	DESCRIPTION OF PART	No. per set	PRICE EACH £ s. d.
6606-27	G1/55	Double-ended spanner (head nuts and wheel cone nuts)	1 ..	1 9
6606-30	G1/55A	Double-ended spanner (head nuts)	1 ..	1 9
6608-31	G1/102	Box spanner	1 ..	1 9
6611-29	G1/77	Box spanner ($\frac{3}{8}$ in.)	1 ..	1 4
6611-31	G1/99	Tube spanner (double-ended) hub spindle nut	1 ..	1 9
6611-34	G1/122	Box spanner	1 ..	1 9
6611-36	G1/123	Tube spanner for clutch centre pins	1 ..	1 4
6611-50	G1/169	Double-ended box spanner (wheel spindle, detachable rear wheel)	1 ..	2 6
6612-27	G1/57	Tommy bar	1 ..	10
6614-29	G1/94	Ring spanner ($\frac{3}{8}$ in. \times $\frac{7}{16}$ in.)	1 ..	3 6
6614-31	G1/103	Ring spanner ($\frac{1}{4}$ in. \times $\frac{3}{8}$ in.)	1 ..	3 6
6615-34	G1/118	Spanner for valve rocker adjustment and cover	1 ..	1 4
6616-26	G1/33	Screwdriver	1 ..	1 4
6616-29	G1/86	Screwdriver for clutch spring nuts	1 ..	10
6617-26		Magneto spanner	1 ..	10
6625-26		Tyre lever	1 ..	10
6635-54		Grease gun	1 ..	7 0
6636-54	42/9025	Tyre inflator	1 ..	7 0
6640-54		Canvas tool roll	1 ..	5 0
6689-46	G1/150	Socket key for front forks	1 ..	1 3
6699-46	G1/152	Spanner for locking ring (front hub)	1 ..	2 3
6701-54	65/9246	Carburettor and tappet adjusting spanner	1 ..	1 3
6702-54	67/9023	Cylinder head bolt box spanner	1 ..	1 8
6703-54	65/9125	Feeler gauge	1 ..	2
6704-54	68/9132	Sparking plug spanner	1 ..	2 0
6688-54		Set of tools only	1 ..	2 4 0
61-3256AR		Service sprocket extractor set	1 ..	15 0

Note.—Set of tools does not include grease gun, tyre inflator or sprocket extractor set.

AIR CLEANER

9003-54	E9/3238	Air cleaner complete	1 ..	1 5 0
9004-54	E9/3249	Rubber connection	1 ..	2 6
9010-54	E9/3266	Spring garter for rubber connection	1 ..	5
9004-52	E9/1396	Adaptor	1 ..	1 0

CARBURETTOR

Makers: AMAL LTD.,
Holdford Road, Witton, Birmingham 6

7700-54		Carburettor complete with cables, less controls 276G/1DB	3 ..	8 8
276/427R		Mixing chamber body	1 ..	15 6
6/403		Mixing chamber top	1 ..	2 9
6/031		Mixing chamber cap	1 ..	2 9
4/276		Cap spring	1 ..	10
4/241		Cap spring screw	1 ..	2
6/132A		Cable stop (top hat shape)	1 ..	3
6/052		Throttle valve 6/4	1 ..	6 8
4/263		Throttle valve spring	1 ..	4
4/060		Throttle valve cotter	1 ..	1
6/045		Air valve	1 ..	4 3

Order by SPARES No.	DESCRIPTION OF PART	PRICE EACH £ s. d.
4/046	Air valve spring	4
6/047	Air valve guide	1 2
1482	Cable nipple	2
4/063	Throttle adjusting screw	10
16/010	Throttle adjusting screw nut	2
13/129	Air adjusting screw	10
4/148	Air adjusting screw spring	3
206/059RLH	Jet block complete	8 3
6/040	Jet block washer	2
4/061	Needle jet	2 9
6/065	Jet needle	2 3
4/230	Jet needle clip	7
4/042	Main jet No. 170	9
6/062	Mixing chamber union nut	2 6
4/043	Holding bolt	3 4
4/053	Holding bolt washer	2
244-603	Air intake tube adaptor	1 3
3792/3/4	Midway cable adjuster	1 8

FLOAT CHAMBER

1DB	Float chamber complete	1 9 6
64/195B	Float chamber body	15 6
14/208	Float chamber cover complete	4 2
14/021	Cover lock screw	4
14/015	Float complete	4 2
14/014	Float bow spring	4
14/024	Needle valve	1 8
14/301	Tickler complete	1 6
14/210	Tickler stop	3
14/032	Tickler spring	2
14/289	Tickler cotter	1
14/209	Needle clip (top feed), tickler only	11
64/353	Platform plug screw (body arm)	3
23/110	Platform plug screw washer	1
14/036	Banjo connection nut	10
14/037	Banjo connection nut washer	2
14/042	Petrol union nut	10
14/026	Petrol union nut nipple	6

ELECTRICAL EQUIPMENT

Makers: Messrs. JOSEPH LUCAS LTD. (Service Dept.),
Great King Street, Birmingham 19 and
Great Hampton Street, Birmingham 18

20009	Generator	
045257	Magneto	
37097	Control box	
057240	SSU700 headlamp complete	
069239	Horn	
76240	Horn push	
PU7E/9	Battery	
53269A	Stop and tail lamp	
352	Bulb	
861492	Stop lamp switch harness	
861491	Stop lamp harness	
31-437A	Stop light switch	

STANDARD NUTS, WASHERS, ETC.

Order by SPARES No.	DESCRIPTION OF PART	PRICE
S1-2	Nut (standard), $\frac{1}{4}$ in. dia. \times 26 T.P.I.	} 2d. each or 1/6 per doz.
S1-3	Nut (standard), $\frac{3}{16}$ in. dia. \times 26 T.P.I.	
S1-4	Nut (standard), $\frac{3}{8}$ in. dia. \times 26 T.P.I.	} 4d. each or 2/6 per doz.
S1-5	Nut (standard), $\frac{7}{16}$ in. dia. \times 26 T.P.I.	
S1-6	Nut (standard), $\frac{1}{2}$ in. dia. \times 20 T.P.I.	
S2-2	Locknut (thin), $\frac{1}{4}$ in. dia. \times 26 T.P.I.	} 2d. each or 1/6 per doz.
S2-3	Locknut (thin), $\frac{3}{16}$ in. dia. \times 26 T.P.I.	
S2-4	Locknut (thin), $\frac{3}{8}$ in. dia. \times 26 T.P.I.	} 4d. each or 2/6 per doz.
S2-5	Locknut (thin), $\frac{7}{16}$ in. dia. \times 26 T.P.I.	
S2-6	Locknut (thin), $\frac{1}{2}$ in. dia. \times 20 T.P.I.	
S5-2	Single spring washer, $\frac{1}{4}$ in. dia.	} 2d. each or 1/6 per doz.
S5-3	Single spring washer, $\frac{3}{16}$ in. dia.	
S5-4	Single spring washer, $\frac{1}{2}$ in. dia.	
S5-5	Single spring washer, $\frac{3}{8}$ in. dia.	
S5-6	Single spring washer, $\frac{1}{2}$ in. dia.	
S6-3	Double spring washer..	} 2d. each or 1/6 per doz.
S6-6	Double spring washer..	
S9-1	Steel ball, $\frac{3}{16}$ in. dia.	} 2d. each.
S9-1A	Steel ball, $\frac{7}{32}$ in. dia.	
S9-2	Steel ball, $\frac{1}{4}$ in. dia.	
S17-1	Split pin, $\frac{1}{16}$ in. dia. \times $\frac{1}{8}$ in.	1d. each.
S19-2	Plain washer, $\frac{1}{4}$ in. dia. hole	} 2d. each or 9d. per doz.
S19-3	Plain washer, $\frac{3}{16}$ in. dia. hole	
S19-4	Plain washer, $\frac{3}{8}$ in. dia. hole	} 2d. each or 10d. per doz.
S19-5	Plain washer, $\frac{7}{16}$ in. dia. hole	
S19-6	Plain washer, $\frac{1}{2}$ in. dia. hole	
S19-7	Plain washer, $\frac{9}{16}$ in. dia. hole	} 2d. each or 1/2 per doz.
S19-8	Plain washer, $\frac{5}{8}$ in. dia. hole	
S48-2	Joint pin	5d. each.
S51-1	Joint pin, battery strap	4d. each.

ARIEL MOTORS LIMITED PROPRIETARY EQUIPMENT AND ACCESSORIES

Although every effort is made to obtain the most suitable and highest quality fittings of a proprietary nature for incorporating into our Motor Cycles, our guarantee does not cover such parts.

In the event of trouble being experienced with proprietary fittings, the part or parts should be returned to and claims made direct on the actual manufacturers, who will deal with them on the terms of their respective guarantees. Date of purchase and mileage covered should always be carefully stated when submitting a claim.

CARBURETTORS

AMAL LTD.,
Holdford Road, Witton, Birmingham 6

CHAINS

THE RENOLD & COVENTRY CHAIN CO. LTD.,
Didsbury, Manchester

DYNAMO, MAGNETO AND LIGHTING EQUIPMENT

Messrs. JOSEPH LUCAS LTD. (Service Dept.),
Great King Street, Birmingham 19 and Great Hampton Street, Birmingham 18

HORNS

CLEAR HOOTERS LTD.,
33 Hampton Street, Birmingham 19
Messrs. JOSEPH LUCAS LTD. (Service Dept.),
Great King Street, Birmingham 19 and Great Hampton Street, Birmingham 18

SPEEDOMETERS

Messrs. S. SMITH (MA) LTD.,
Cricklewood, London

TYRES

THE DUNLOP RUBBER CO. LTD.,
Fort Dunlop, Erdington, Birmingham 24

SPARKING PLUGS

CHAMPION SPARKING PLUG CO. LTD.,
Feltham, Middlesex
LODGE PLUGS LTD.,
Rugby

GEARBOXES

Messrs. BURMAN & SONS LTD.,
Wychall Lane, Kings Norton, Birmingham 30

NOTICE

WE do not appoint agents for the sale on our behalf of our motor cycles or other goods, but we assign to motor cycle Dealers areas in which we supply to such Dealers, exclusively for re-sale in such areas. No such Dealer is authorised to transact any business, give any warranty, make any representation or incur any liability on our behalf.

THE FOLLOWING IS A COPY OF THE GUARANTEE GIVEN BY DEALERS IN ARIEL MOTOR CYCLES

WE give the following guarantee with our motor cycles, which is given in place of any implied conditions, warranties or liabilities whatsoever, statutory or otherwise, all such implied conditions, warranties, and liabilities being in all cases excluded. Any statement, description, condition or representation contained in any catalogue, advertisement leaflet or other publication, shall not be construed as enlarging, varying or overriding this guarantee. In the case of machines which have been used for "hiring out" purposes, or from which the trade mark, name or manufacturing number has been removed, no guarantee of any kind is given or is to be implied.

WE guarantee, subject to the conditions mentioned below, that all precautions which are usual and reasonable have been taken by us to secure excellence of materials and workmanship, but this guarantee is to extend and be in force for six months only from date of purchase, and damages for which we make ourselves responsible under this guarantee are limited to the free supply of a new part in exchange for the part of the motor cycle which may have proved defective. We do not undertake to replace or refix, or bear the cost of replacing or refixing such new part in the motor cycle. We undertake, subject to the conditions mentioned below, to make good at any time within six months any defects in these respects. As the motor cycles are easily liable to derangement by neglect or misuse, this guarantee does not apply to defects caused by wear and tear, misuse or neglect.

The term "misuse" shall include, amongst others, the following acts:

1. The attaching of a sidecar to the motor cycle in such a manner as to cause damage or calculated to render the latter unsafe when ridden.
2. The use of a motor cycle, or of a motor cycle and sidecar combined, when carrying more persons, or a greater weight than that for which the machine was designed by the manufacturers.
3. The attaching of a sidecar to a motor cycle by any form of attachment not provided, supplied or approved by the manufacturers, or to a motor cycle which is not designed for such use.

Any motor cycle sent to us to be plated, enamelled or repaired will be repaired upon the following conditions, i.e., we guarantee that all precautions which are usual and reasonable have been taken by us to secure excellence of material and workmanship, such guarantee to extend and be in force for three months only from the time such work shall have been executed or until the expiration of the six months above referred to, and this guarantee is in lieu and in exclusion of any common law or statute warranty or condition and the damages recoverable are limited to the cost of any further work which may be necessary to amend and make good the work found to be defective.

CONDITIONS OF GUARANTEE

If a defective part should be found in our motor cycles, or in any part supplied by way of exchange before referred to, it must be sent to us **Carriage Paid**, and accompanied by an intimation from the Owner that he desires to have it repaired or exchanged free of charge under our guarantee, and he must also furnish us at the same time with the number of the machine, the date of purchase, or the date when the alleged defective part was exchanged as the case may be.

Failing compliance with the above, such articles will lie here **at the risk of the owner**, and this guarantee and any implied guarantee, warranty or condition shall not be enforceable.

We do not guarantee tyres, saddles, chains, electrical equipment or any other specialities of accessory manufacturers.

ARIEL DISTRIBUTORS AND SPARES STOCKISTS

ABERFFRAW, Anglesey	...	J. O. Williams, Llewelyn Street.
ACCRINGTON, Lancs.	...	Wm. Snape, 379 Blackburn Road.
ALDESHOT, Hants.	...	Archer & Son, 149 Victoria Road.
ALTRINCHAM, Cheshire	...	Walton & Coombes Ltd., 13 Old Market Place.
ALTRINCHAM, Cheshire	...	Walton & Coombes Ltd., 28A Greenwood Street.
ANDOVER, Hants.	...	Corbett & Ellis Ltd., Weyhill Road.
ANDOVER, Hants.	...	Chas. White, Lower Clatford.
ASHBY-DE-LA-ZOUCH	...	Motor Cycle Spares, 82 Market Street.
ASHFORD, Kent	...	C. Hayward & Son Ltd., 20-46 New Street.
ASHFORD, Middx.	...	C. & A. Motors Ltd., London Road.
AYLESBURY, Bucks.	...	Ebom's Garage, 44 Walton Street.
BALA, Merioneth	...	Jones Bros., Herblas and West End Garage.
BARRING, Essex	...	Albons Garage Ltd., 119 Ripple Road.
BARNLEY, Yorks.	...	Geo. Ward, 40-42 Doncaster Road.
BARNSTAPLE, Devon	...	Bob Ray, 43 High Street.
BARROW-IN-FURNESS	...	H. Jackson, Roose Garage.
BASINGSTOKE, Hants.	...	H. J. Gifford Ltd., 14 New Street.
BATH, Som.	...	Barton Motors, 14 Westgate Buildings.
BEAUFORT, Mon.	...	Beaufort Garage Co.
BEDEFORD	...	Imperial Cycle & Motor Co., 55 St. Laves.
BECCLES, Suffolk	...	L. C. Green, Southwold Road, Wrentham.
BECKENHAM, Kent	...	Deen's Garage, 529 Croydon Road.
BEOLEY, Worcs.	...	Beoley Garage Ltd., Bransons Cross, Alrester Road, near Redditch.
BIGGLESWADE, Beds.	...	Brevants Ltd., 72-74 Shortmead Street.
BIRCHINGTON, Kent	...	Hallits (Canterbury), The Square.
BIRKENHEAD, Cheshire	...	Bob Simister, 541 New Chester Road, Rock Ferry.
BIRMINGHAM 5	...	Colliners Depot Ltd., 77 Station Street.
BIRMINGHAM 17	...	Chas. E. Cope & Sons Ltd., 481-487 Upper Hagley Road, Edgbaston.
BIRMINGHAM 1	...	W. L. Handley Ltd., 144-145 Suffolk Street.
BIRMINGHAM 5	...	Kings Motors (Oxford) Ltd., 18-20 Bristol Street.
BIRMINGHAM 4	...	Motor Sales Ltd., 15-16 Aston Street.
BIRMINGHAM 23	...	Kickart's Garage, 84 Station Road, Edgbaston.
BIRMINGHAM 12	...	Saundersons Ltd., 978 Ladywell Road, Sparkbrook.
BIRMINGHAM 7	...	The Premier Motor Co. Ltd., 253 Dartmouth Street.
BISHOPS STORTFORD, Herts.	...	W. Seaming, 31 Hockerill Street.
BLACKBURN	...	Shuttleworth & Goldart, 18 Gl. Bolton Street.
BLACKPOOL	...	Nick Lancaster, 53 Whitegate Drive.
BLACKPOOL	...	John Hall & Son, 102-103 Devonshire Drive.
BLACKPOOL	...	John Hall & Son, 143 Church Street.
BLANDFORD, Dorset	...	Porter & Thomas, Badger Garage, Salisbury Road.
BOLTON	...	Kay Bros., Motor & Cycle Agents, Bradshawgate.
BOURNE, Lincs.	...	H. J. Wilson, Windmill Garage, Rippingale.
BOURNEMOUTH	...	Jenkins & Parser Ltd., 970 Winborne Road.
BRADFORD	...	Chas. Sidney Ltd., 140 Manningham Lane.
BRAINTREE, Essex	...	J. H. Tofts & Son Ltd., The Garage, Great Square.
BRAUNTON, Devon	...	C. M. Ray, 7 Caen Street.
BRECON	...	Treyor Brothers, Lion Street.
BRENTWOOD, Essex	...	Albons Garage (Sheffield) Ltd., Sheafed Garage, Sheafed, near Brentwood.
BRIDGEND, Glam.	...	Leslie Griffiths, Eweany Road.
BRIDGWATER, Som.	...	Anderson & Wall, 18 St. Mary Street.
BRIGG, Lincs.	...	Sid. Whelpton, West End Garage, Forrester Street.
BRIGHOUSE, Yorks.	...	Belle Vue Garage, Bradford Road.
BRIGHTON, Sussex	...	Redhill Motors Ltd., 104 North Road.
BRISTOL	...	Barton Motors (Bristol) Ltd., 17-18 North Street.
BRISTOL	...	Glanfield Lawrence (Bristol) Ltd., 47-53 Bath Road.
BROMLEY, Kent	...	Boyer of Bromley, 38 London Road.
BROMSGROVE, Worcs.	...	Harold Tozer Ltd., 110 Birmingham Road.
BRYNMAWK	...	Jaynes Motors, Cym-Bach Garage.
BURNLEY, Lancs.	...	H. & F. Hebden Ltd., 149 St. James Street.
BURTON-ON-TRENT	...	Bargate Motors Ltd., 3 and 4 Westmore Road.
BURY, Lancs.	...	Cliff Holden (Motors) Ltd., 40 Bolton Street.
BURY-ST.-EDMUNDS	...	C. J. Bowers & Son, 98A Kisbygate Street.
CAERNARVON	...	J. O. Williams, Brunswick Buildings, Castle Square.
CAERPHILLY, Glam.	...	C. G. Morgan, Piccadilly Square.
CALNE, Wilts.	...	Ross & Haines, 10 New Road.
CAMBERLEY, Surrey	...	E. Pascall Ltd., 42-45 London Road.
CAMBRIDGE	...	King & Harper Ltd., 3 Milton Road.
CANNOCK, Staffs.	...	T. E. Stone, Central Garage, Blackfords.
CANTERBURY, Kent	...	Marcel Hallett, St. Dunstan's Garage.
CARDIFF	...	Glanfield Lawrence Ltd., 2-10 City Road.
CARLISLE	...	W. T. Tiffin & Sons, Irishgate House, Caldew Bridge.
CARMARTHEN	...	Eddie Stephens Motors, 22-23 Water Street.
CASTLEFORD	...	Barrett's Motor Cycles Ltd., 27 Aire Street.
CHAPEL-EN-LE-FRITH	...	E. W. Bowers, 129 Townend.

ARIEL DISTRIBUTORS AND SPARES STOCKISTS—continued

CHARD, Som.	...	E. A. Taylor, Holyrood Street.
CHATHAM, Kent	...	F. Bannister & Son Ltd., 28 Railway Street.
CHELMSFORD, Essex	...	G. W. Boreham, City Garage, Baddow Road.
CHELTENHAM	...	A. Williams & Co., Portland Street.
CHEPSTOW, Mon.	...	Bowen's Garage Ltd., Tutshill.
CHESTER	...	Davies Bros., 34 Bridge Street.
CHRISTEFIELD	...	Jarvis Bros., Horas Garage, 95 Lordsmith Street.
CHICHESTER, Sussex	...	W. Goddridge & Co. Ltd., East Street and Market Road.
CHIPPENHAM, Wilts.	...	Ross & Haines, 4 Causeway.
CHORLEY, Lancs.	...	S. M. Miller, 88 Bolton Street.
CHURCH STRETTON, Salop	...	The Central Garage Ltd., Burway Road.
CLAFTON-ON-SEA	...	W. A. Syrett, 109 Station Road.
COLCHESTER, Essex	...	G. B. R. Motors Ltd., 63 High Street.
COLNE, Lancs.	...	C. H. Schofield (Motors) Ltd., 15 Market Place.
COVENTRY	...	W. Brandish & Son Ltd., Whitefriars Street.
COVENTRY	...	Chas. E. Cope & Sons Ltd., 282-284 Foleshill Road.
COVENTRY	...	Chas. E. Cope & Sons Ltd., 5 Holyhead Road.
CREWE	...	E. Beech, Coppenhall Garage, Cross Green.
CREWE	...	W. M. Webster, Mill Street Garage.
CREWKERNE, Som.	...	E. A. Taylor, 14 East Street.
CROOK, Co. Durham	...	F. Clement, Bridge Street Garage.
CROYDON, Surrey	...	Godfreys Ltd., 228-234 London Road.
CULLOMPTON, Devon	...	R. Edwards, Ashill Craddock.
DAGENHAM, Essex	...	Smith & Double Ltd., Imperial House, New Road.
DARLINGTON	...	Duplex Motor & Cycle Co. Ltd., 10-16 Grange Road.
DARTFORD, Kent	...	Schwies Bros., 177 Lowfield Street.
DEAL, Kent	...	Water Street Garage, Water Street.
DERBY	...	Palms Motors Ltd., 43 Osmaston Road.
DEVIZES, Wilts.	...	K. L. Witts, Southbrook Place.
DONCASTER, Yorks.	...	Ravens Motors, 10 Cleveland Street.
DORCHESTER, Dorset	...	R. J. Watts, 39 South Street.
DORKING, Surrey	...	Edwards Motors (Dorking) Ltd., South Street.
DOUGLAS, Lo.M.	...	Salisbury Garages Ltd., Fort Street.
DOVER, Kent	...	Kearsney Motor Garage Ltd., Kearsney.
DUDLEY, Worcs.	...	Chas. E. Cope & Sons Ltd., 193 High Street.
DUNSTABLE, Beds.	...	B. G. England Ltd., Half Moon Garage, London Road.
DURHAM	...	Gibson & Woods, 54 North Road.
EASTBOURNE, Sussex	...	Hurrey Woodhams Ltd., 3 Gildredge Road.
EASTBOURNE, Sussex	...	Hurrey Woodhams Ltd., 118 Seaside.
EDGEWARE, Middx.	...	Rex Judd, High Street.
ELY, Cambs.	...	Walbro Cycle Stores, 3 Lynn Road.
EMSWORTH, Hants.	...	A. G. Motor Cycles, 1 South Street.
ENFIELD, Middx.	...	D. J. Shepherd & Co. Ltd., 434-436 Hertford Road.
ENFIELD, Middx.	...	D. J. Shepherd & Co. Ltd., 10 Sayov Parade.
EPSOM, Surrey	...	Wheeler Motors, 45-51 Waterloo Road.
ERITH, Kent	...	A. A. Heiden, Fraser Road.
EVESHAM, Worcs.	...	The Motor House, London Road.
EXETER, Devon	...	P. Pike & Co. Ltd., Alphington Street.
EYE, Suffolk	...	F. E. Whant & Son, Broad Street.
FALMOUTH, Cornwall	...	J. Pengelly & Sons, Webber Street.
FARNHAM, Surrey	...	Heath Bros. (Farnham) Ltd., 83 East Street.
FLEETWOOD, Lancs.	...	Nick Lancaster, 48-50 Poulton Road.
FOLKESTONE, Kent	...	K. O. Whitshire, 28 Kennervous Street.
FRITHVILLE, Lincs.	...	S. Coupland, near Boston.
FROME, Som.	...	P. Difazio & Bishop, 25 Catherine Street.
GAINSBOROUGH, Lincs.	...	Central Garage Ltd., North Street.
GATESHEAD-ON-TYNE	...	O. Cammichael & Son, 75 High West Street.
GLOUCESTER	...	Harpers Garage Ltd., 23a Worcester Street.
GRANTHAM, Lincs.	...	Grantham Motor Cycle Depot, 5 Chapel Street.
GRIMSBY	...	H. J. Gresswell & Son Ltd., 12-15 Osborne Street.
GRIMSBY	...	Fredie Frith, 119 Victoria Street.
GT. YARMOUTH	...	O. Atkinson, 137 Mill Road.
GUILDFORD, Surrey	...	E. Pascall Ltd., 11-12 Woodbridge Road.
HALIFAX, Yorks.	...	Cable Motor Co. Ltd., 26 Lister Lane.
HALIFAX, Yorks.	...	Halifax Motor Exchange, 25 Horton Street.
HAMPTON-IN-ARDEN	...	J. Pearson's Garage, Barston.
HARLOW, Essex	...	Collins & Son, Fore Street.
HARROWGATE, Yorks.	...	Baines Bros. Ltd., 29 Station Parade.
HARROW, Middx.	...	E. T. Pink, 22 Station Road.
HAYWARDS HEATH, Sussex	...	C. G. Griffiths Ltd., Queens Road.
HAZEL GROVE, Cheshire	...	Warburton Bros., 260 London Road.
HEANOR, Notts.	...	W. S. Humphrey Ltd., 94 Market Street.
HELSTON, Cornwall	...	C. G. Lory, 14-16 Wendron Street.
HEDNESFORD, Staffs.	...	T. E. Stone, 80 Plackett Street.
HEMEL HEMPSTEAD, Herts.	...	Messrs. Moores, London Road.

ARIEL DISTRIBUTORS AND SPARES STOCKISTS—continued

HENLEY-IN-ARDEN, Warwicks.	...	Henley Garages Ltd., High Street.
HEREFORD	...	C. F. King & Co., City Garage, Eign Street.
HIGH WYCOMBE, Bucks.	...	F. W. Tilton, Priory Road.
HINCKLEY, Leics.	...	Bruce Lewin Ltd., 16 Stockwell Head.
HORSHAM, Sussex	...	Harold Lines, 48 Springfield Road.
HORWICH, Lancs.	...	Martins Motors, 75 Back Chorley New Road.
HORWICH, Lancs.	...	Martins Motors, 222 Chorley New Road.
HOVE, Sussex	...	G. Bradshaw (Sussex) Ltd., 5-8 Western Road.
HOUNSFLOW, Middx.	...	Stanley Motors, 7-8 Bulstrode Parade and Nobel Corner.
HUDDERSFIELD	...	Arnold Moore, Oxford Street Garage, Northgate.
HULL	...	Jordan & Co. (Hull) Ltd., Storey Street.
ILFORD, Essex	...	Smith & Double Ltd., 1-4 Midway Parade, Cranbrook Road.
ILFORD, Essex	...	Morgans of Ilford, 7 York Road.
IPSWICH, Suffolk	...	Revetts Ltd., 1 Berners Street.
KEIGHLEY, Yorks.	...	Dick Ratcliffe, Coldshaw Garage, Haworth.
KENDAL	...	G. W. Parkinson, Kent Street.
KENFIG HILL, Glouc.	...	Cyril Kieft (Sales) Ltd., Foster Buildings.
KETERING, Northants.	...	C. J. Rouse & Son, 114 Wellington Street.
KETERING, Northants.	...	R. V. Barrows (Motor Cycles), Barton Seagrave.
KIDDERMINSTER, Worcs.	...	Motor Cycle Mart, 9 Towers Buildings, Blackwell Street.
KINGSBRIDGE, Devon	...	Wills Garage, Embankment Road.
KING'S LYNN, Norfolk	...	John Brooker Ltd., Towers Street.
KINGSTON-ON-THAMES, Surrey	...	Kingston Motor Cycles Ltd., 26-28 London Road.
LANCASTER	...	J. P. Barton, Darnside Street.
LANCASTON, Cornwall	...	H. Robbins, Northgate Street.
LEAMINGTON SPA	...	Beauchamp Motors, Hall Road.
LEEDS	...	B. J. Jenkins (Leeds) Ltd., 31 Lower Briggate.
LEEDS 6	...	W. Marsden & Sons Ltd., Hyde Park Corner.
LEEK, Staffs.	...	Calob Tritterton, East Street.
LEICESTER	...	Colmore Depot Ltd., 174 Belgrave Gate.
LEIGH, Lancs.	...	Cliff Holden (Motors) Ltd., Market Buildings, Newton Street.
LEOMINSTER, Hereford	...	Watson's Motor Works Ltd., 4 Etnam Street.
LICHFIELD, Staffs.	...	The Lichfield Motor Cycle Depot, 37 Tamworth Street.
LILYTON	...	West's (Lincoln) Ltd., 118 High Street.
LIVERPOOL 2	...	Bob Sergeant Ltd., 22 Moorfields.
BLANGFERN, Anglesey	...	J. O. Williams, 11 Church Street.
LONDON N.1	...	Renno's, 232 Upper Street, Islington.
LONDON N.4	...	Strand Motor Cycles, 325 Hornsey Road.
LONDON N.4	...	Strand Motor Cycles, 40 Stroud Green Road.
LONDON N.4	...	Strand Motor Cycles, 449 Green Lane.
LONDON N.6	...	Garagehouse Motors Ltd., 1 Hampstead Lane, Highgate Village.
LONDON N.8	...	Messrs. Brookers, 2 Queens Parade, Green Lanes, Harringay.
LONDON N.12	...	Clanfield Lawrence Ltd., 407 High Road, North Finchley.
LONDON N.13	...	Turner Bros. Ltd., 29-31 Green Lanes, Palmers Green.
LONDON N.15	...	Godfreys Ltd., 94-96 High Street, Tottenham.
LONDON N.16	...	Godfreys Ltd., 232 Stamford Hill.
LONDON N.18	...	J. A. Lock, 88 Fore Street, Edmonston.
LONDON N.W.1	...	W. E. Humphreys Ltd., 122 Hampstead Road.
LONDON N.W.3	...	Rowland Smith's Motors Ltd., 78-81 High Street, Hampstead.
LONDON N.W.6	...	Ravens Way Motors Ltd., 36-38 Wilsden Lane.
LONDON N.W.9	...	O'Neill Bros., 190 Broadway, West Hendon.
LONDON N.W.10	...	Arm Motor Cycle Co. Ltd., 85 Church Road, Willesden.
LONDON N.W.10	...	Slocumbes Ltd., 269-271 Neasden Lane.
LONDON E.C.4	...	Geo. Grose Ltd., Ludgate Circus.
LONDON E.6	...	E. E. Atkinson Motors Ltd., 415 Barking Road, East Ham.
LONDON E.9	...	Godfreys Ltd., 220 Barking Road, East Ham.
LONDON E.7	...	Godfrey Ltd., 418 Rountford Road, Forest Gate.
LONDON E.8	...	Eleanor Motors, 265-269 Mare Street, Hackney.
LONDON E.10	...	S. A. Coles Ltd., 364-368 High Road, Leyton.
LONDON E.11	...	Rivetts Ltd., 236 High Road, Leytonstone.
LONDON E.13	...	Sid. Franklin, 480 Barking Road, Plaistow.
LONDON E.16	...	Wag Bennett, 48-50 Victoria Dock Road.
LONDON S.E.5	...	Marble Arch Motors Ltd., 286-302 Camberwell Road.
LONDON S.E.9	...	E. Beckett, 25 The Courtyard, High Street, Hitham.
LONDON S.E.10	...	M. F. Skarland Ltd., 125 Trafalgar Road, Greenwich.
LONDON S.E.11	...	Writers Ltd., 161-165 Kennington Lane.
LONDON S.E.13	...	T. J. Ross Ltd., 106 Lee High Road, Lewisham.
LONDON S.E.14	...	L. S. Corbett, 410-456 New Cross Road.
LONDON S.E.15	...	West End Motors Ltd., 171 High Street, Peckham.
LONDON S.E.18	...	Cleare & Co. Ltd., 1 Woolwich High Street.
LONDON S.E.18	...	Carter & Hartley, 289 Plumstead High Street.
LONDON S.E.22	...	Tom Pullin Motors, 84 Ladbroke Lane, East Dulwich.
LONDON S.E.23	...	Brackpool & Co. Ltd., 224-228 Stanstead Road, Forest Hill.
LONDON S.E.24	...	J. T. Wise & Son Ltd., Ralton Road, Herne Hill.
LONDON S.E.27	...	E. Withers, 88 Knights Hill, West Norwood.
LONDON S.W.2	...	T. C. Munday & Co. Ltd., 124 Dalberg Road, Brixton.
LONDON S.W.2	...	Geo. Clarke (Motors) Ltd., 278 Brixton Hill.

ARIEL DISTRIBUTORS AND SPARES STOCKISTS—continued

LONDON S.W.5	Claude Rye Ltd., 895 Felham Road.
LONDON S.W.9	Pride & Clarke Ltd., 138 Stockwell Road, Brixton.
LONDON S.W.9	Gus Kuhn Motors, 275 Clapham Road.
LONDON S.W.11	Naylor & Root Ltd., 250 Lavender Hill, Clapham Junction.
LONDON S.W.12	Taylor Motors Ltd., 81-85 Bedford Hill, Balham.
LONDON S.W.14	Ray Kempster, 346 Upper Richmond Road, East Sheen.
LONDON S.W.15	Putney Autos Ltd., 265 Putney Bridge Road.
LONDON S.W.17	Elite Motors Ltd., 951 Garrett Lane, Tooting.
LONDON W.1	Godfreys Ltd., 268-210 Portland Street.
LONDON W.2	Marble Arch Motors Ltd., 113-115 Edgware Road.
LONDON W.3	Whitby's of Acton Ltd., 273 The Vale, Acton.
LONDON W.8	F. Freeman (Hammersmith) Ltd., 92-94 Hammersmith Bridge Rd.
LONDON W.8	Harry Nash (Motors) Ltd., 337-391 King Street, Hammersmith.
LONG EATON, Notts.	H. E. Butler, 72 Tanworth Road.
LOUGHBOROUGH, Leics.	Colmore Depot Ltd., 138 Nottingham Road.
LOWESTOFT, Suffolk	R. Wright, 67-69 London Road South.
LUTON, Beds.	B. G. England (Luton) Ltd., 39 Dunstable Road.
MACCLESFIELD	T. Simister, Hibel Road and Station Road.
MACHYNLETH, Mon.	F. Reade & Sons, The Garage.
MAIDENHEAD, Berks.	Bob White & Co., 15 York Road.
MAIDSTONE, Kent	Redhill Motors Ltd., 4 The Broadway.
MALDON, Essex	H. Nicholls, 120 High Street.
MANCHESTER	Colmore Depot Ltd., 17 Watson Street.
MANCHESTER	King's Motors (Oxford) Ltd., 270 Chester Road, Stretford.
MANSFIELD, Notts.	Henstocks, 128 Chesterfield Road North.
MARCH, Cambs.	H. Rose & Son, St. Peters Road.
MARKET DRAYTON	Abraham's, Shrewsbury Road.
MATFIELD, Kent	West Kent Motor Cycles.
MELTON MOWBRAY, Leics.	W. H. Houghton & Co., 15 Nottingham Street.
MEXBOROUGH, Yorks.	Wilson Bros., 52 Main Street.
MIDDLESBROUGH	Wm. Armstrong Ltd., 379-381 Linthorpe Road.
MISTERTON, nr. Crewe, Cheshire	E. A. Taylor.
MITCHAM, Surrey	Millars Motors Ltd., 363 London Road.
MONMOUTH	J. G. Davis, 53 Moorow Street.
NARBERTH, Poms.	James Bowen & Sons, Llawhadan.
NEATH, Glam.	Windsor Motors, 105-6 Windsor Road.
NELSON, Lancs.	J. H. Hebdon Ltd., 71 Scotland Street.
NEWBURY, Berks.	Wheeler's (Newbury) Ltd., Broadway.
NEW BARNET, Herts.	Eleanor Moores, 53-62 East Barnet Road.
NEWCASTLE-ON-TYNE	Dent Motor Co. Ltd., Haymarket.
NEWCASTLE-UNDER-LYME	Chas. E. Cope & Sons (Stuffs), Ltd., 10-12 George Street.
NEW MALDON, Surrey	Meeleus Motor Mecca, Shannon Corner, Kingston By-Pass.
NEWPORT, Lo.W.	Stagg Motors Ltd., 24 South Street.
NEWPORT, Mon.	Alex. Thom, 261 Corporation Street.
NEWTON ABBOT, Devon	J. E. Green & Co., 37 Queen Street.
NEWQUAY, Cornwall	F. & F. J. Parkin, Parkland Garage.
NORTHAMPTON	Spokes & Son, 1 Henry Street.
NORWICH	Chapmans (Norwich) Ltd., 40-42 Duke Street.
NOTTINGHAM	Henstocks, Hollystone Garage.
NUNEATON, Warwicks.	Nuneaton Motor Cycle Depot, 61 Abbey Street.
OAKENGATES, Salop	M. Luter & Son, The Garage, Priors Lee Road, Saeodshill.
OLDHAM	Davenport Motors, 76-78 Lees Road.
OSWESTRY, Salop	E. Roy Evans (Motor Cycles), The Garage, Willow Street.
OXFORD	King's Motors (Oxford) Ltd., New Road.
PARKSTONE, Dorset	Homesead Garages, 228 Ringwood Road.
PENRITH, Cambs.	J. B. Milburn Ltd., Middlegate.
PETERBOROUGH	Burrows Bros., 57 Westgate.
PETERSFIELD, Hants.	P. W. Tew & Son, 20 Lavant Street.
PLYMOUTH	P. Pike & Co., 46 Union Street, Stonehouse.
PONTARDULAIS	T. Griffiths, Forest Garage.
PONTARDAWE, Glam.	H. Francis & Son, 12-14 High Street.
PONTEFRAC, Yorks.	Ewbank & Son, Townend.
PORTHCAWL, Glam.	Dunn & Alpin Ltd., 52 New Road.
PORTSLADE, Sussex	Beauchamp Motors Ltd., 123 Gardner Road.
PORTSMOUTH	E. W. Burnett & Sons, 5 Eldon Street.
PORTSMOUTH	Glanfield Lawrence Ltd., 147-151 Fratton Road.
PORTSMOUTH	Jenkins & Purser Ltd., 277-281 Copnor Road.
PORTSMOUTH	Jenkins & Purser Ltd., 144-148 Lake Road.
PORT TALBOT, Glam.	Dunn & Alpin Ltd., 58 Commercial Road.
PRESTON, Lancs.	Stan. Marks Ltd., 215 Lancaster Gate.
PULBOROUGH, Sussex	Gray & Rowell, Bury Gate.
RAMSGATE, Kent	Phillipott's Garage, Canterbury Road.
RAWNSTALL, Lancs.	W. Snape, 3 Bacup Road.
READING, Berks.	Phillips & Bloomfield Ltd., South Street.
READING, Berks.	Stocker & Shepherd Ltd., 4 Waylen Street.

ARIEL DISTRIBUTORS AND SPARES STOCKISTS—continued

READING, Berks.	Stocker & Shepherd Ltd., 129-131 Oxford Road.
REDHILL, Surrey	Redhill Motor & Cycle Works Ltd., 50 Brighton Road.
REDRUTH, Cornwall	Joe Pearely & Son, 85 Higher Fore Street.
RETFORD, Notts.	Lambert's Motor Cycle Depot, 72 Carrolgate.
RHONDDA, Glam.	Phil. Jones & Son, Ystrad.
RICHMOND, Surrey	Harwoods Motor Cycles, 14-16 Kewfoot Road.
RIPLEY, Yorks.	L. Middleton, Derby Road.
ROCHDALE, Lancs.	Ben. Drinkwater Ltd., 48 Milnrow Road.
ROMFORD, Essex	G. H. Wilson, 119 George Street.
ROSS-ON-WYE	Little & Hall, 48 Broad Street.
ROTHERHAM	Wilson Bros., 95 Sheffield Road.
RUGBY	Underwood's Garage Ltd., 1 Park Road.
RYE, Sussex	W. Canzier, 7 Wish Ward.
SALISBURY, Wilts.	Pankhurst Ltd., 78-79 Exeter Street.
SALISBURY, Wilts.	Mavro & Son, St. Thomas's Square.
SANDBACH	Chf. Dickenson, The Commons Garage.
SAXMUNDHAM, Suffolk	Earle & Kent Ltd., Chantry Road.
SCARBOROUGH	Fairbairn-Laycock Ltd., 10 Falsgrave Road.
SCUNTHORPE, Lincs.	R. L. Ward, 18-22 High Street.
SEVEN KINGS, Essex	Raymond Way Motors Ltd., 773 High Road.
SHEERNESS, Kent	Nokes Garage, 156 High Street.
SHEFFIELD 2	Dan. Bradbury (Motor Cycles) Ltd., 224-230 London Road.
SHEFFIELD 2	Horridge & Wildgoose Ltd., 292 London Road.
SHIFNAL, Shrop.	M. Luter & Sons, 14 Market Place.
SHIPLEY, Yorks.	Messrs. Jellies, 129 Saltaro Road.
SHIPTON-ON-STOUR, Warwicks	A. R. Taylor Garages Ltd., Church Street.
SHORHAM, Sussex	Gray, Rowell & Baker Ltd., Lower Brighton Road.
SHREWSBURY, Shrops.	F. Parslow, Frankwell.
SHREWSBURY, Shrops.	J. C. Pickering, 49 Mardol.
SHREWSBURY, Shrops.	F. Parslow Motor Cycles, 3 Greafrians.
SIDCUP, Kent	Arrow Motor Works (Kent) Ltd., High Street, Footscray.
SITTINGBOURNE, Kent	Sittingbourne Motor Cycles, 2 London Road.
SLEAFORD, Lincs.	Craven Motor Co. Ltd., 40-42 High Street.
SLOUGH, Bucks.	W. P. Maidens, Auto Engineers, Southgate.
SLOUGH, Bucks.	Sid. Moran Ltd., Wexham Road Corner.
SLOUGH, Bucks.	Sid. Moran Ltd., 243 High Street.
SOUTHAMPTON	Alec Bennett Ltd., 192 Portswood Road.
SOUTHAMPTON	Jenkins & Purser Ltd., 349-353 Shirley Road.
SOUTHEND-ON-SEA	Belle Vue Motors, 480-484 Southchurch Road.
SOUTHPORT, Lancs.	Lifes Motors Ltd., West Street.
SOUTHSEA, Herts.	E. W. Burnett & Sons, 5 Eldon Street.
SOUTH SHIELDS	G. Arthur Brown, 103 Fowler Street.
SPALDING, Lincs.	Gordon Woodman Ltd., 34 Fleet Street, Holbeach.
SPILSBY, Lincs.	C. E. Roberts, Boston Road.
STAFFORD	Ernest H. Baun, The Garage, 11 Newport Road.
STALYBRIDGE, Cheshire	W. Sellers & Sons, 174 Scamiger Street and Mottram Road.
STAMFORD, Lincs.	Ross Motors Ltd., 1 Red Lion Street.
STAPLEFORD, Notts.	Blackwell Motors Ltd., 79 Nottingham Road.
STOCKPORT	Warburton Bros., 260 London Road.
STOCKPORT, Cheshire	Theobald & Coppock, 8 Chestergate.
STOCKTON-ON-TEES	Stan. Jones Ltd., Bridge Road.
STOKE-ON-TRENT	Broadway Motors, Liverpool Road.
STORE-ON-TRENT	Ridgways, 54-56 Market Street, Loughton.
STONY STRATFORD, Berks.	R. J. Fleming Ltd., 25 High Street.
STRATFORD-UPON-AVON	Mathews & Co. Ltd., 49-50 Mansell Street.
STREET, Som.	Jim Alves & Co., 97 High Street.
ST. ALBANS, Herts.	W. M. Couper Ltd., Catherine Street.
ST. ANNES-ON-SEA	Edgar Summer Ltd., St. Andrews Road South.
ST. HELENS, Lancs.	Geoff. Duke Ltd., Greenfield Road Garage.
ST. IVES, Herts.	Bridge Motors Ltd., The Bridge Garage.
ST. LEONARDS-ON-SEA	Marina Motors Ltd., 5 Bexhill Road.
STIBBURY, Suffolk	W. C. Green, North Street.
SUNDERLAND	Dunn's Garages Ltd., 53-54 North Bridge Street.
SUTTON COLDFIELD	Premier Motor Co., 49 Birmingham Road.
SUTTON-IN-ASHFIELD	Henstocks, Forest Street Garage.
SWANSEA, Glam.	J. Brayley, 15 Picton Place.
SWANSEA, Glam.	Handle Davies Ltd., 230 Oxford Street.
SWINDON, Wilts.	Swindon Motor Co. Ltd., 34 Wood Street.
TALSARNAU, Merioneth	R. J. Williams, The Garage.
TAMWORTH, Staffs.	The Motor Cycle Shop, 72 Bolesbridge Street.
TAINION, Som.	W. P. Edwards (Motors) Ltd., 88 East Street.
THAMES DITTON, Surrey	Commerford's Ltd., Portsmouth Road.
THETFORD, Norfolk	W. & G. Lambert Ltd., Castle Street.
THIRSK, Yorks.	J. Moss, Flakke Street.
THORNBURY, nr. Bristol	T. H. Ashcroft, Silver Street.
TRURO, Cornwall	W. H. Collins & Son, Kenwyn Mews.
TROWBRIDGE, Wilts.	Jack Plover, Mid Street.
TUNBRIDGE WELLS, Kent	F. R. Philpot, 11 St. Johns Road.
TWICKENHAM, Middx.	Blay's of Twickenham, 192 Heath Road.

ARIEL DISTRIBUTORS AND SPARES STOCKISTS—continued

UXBRIDGE, Middx.	Miles Motors, 60 High Street.
WAKEFIELD, Yorks.	Parkinsons Ltd., 38-45 Ings Road.
WALSALL, Staffs.	The Motor Cycle Mart Ltd., 12 Ablewell Street.
WARRINGTON, Lancs.	Jack Frodsham Ltd., 37A Wivewick Street.
WARMINGSTER, Wilts.	Alf. Hickin, 1 George Street.
WATFORD, Herts.	Lewis, Ellis & Foster Ltd., 294 Rickmansworth Road.
WATFORD, Herts.	Lloyd Cooper & Co. Ltd., 61 Queens Road.
WATFORD, Herts.	Marble Arch Motor Supplies Ltd., High Street.
WATFORD, Herts.	Watford Motor Cycle & Spares Service Ltd., 239-241 High St.
WELDON, Northants.	R. V. Burrows Motor Cycles, High Street.
WELLING, Kent	A. Francis, 178 Park View Road.
WELLINGTON, Salop	F. Pieslow, 99 Kings Street.
WELLINGBOROUGH	W. H. Mason Ltd., 39 Midland Road.
WEMBLEY, Middx.	Bolt Keeler Ltd., 129-131 Ealing Road.
WEM, Salop	Peter Moss, 12 New Street.
WEST HARTLEPOOL	Robt. Robinson Ltd., Avenue Road.
WESTON-SUPER-MARE	Wyverns of Weston Ltd., 47 Drove Road.
WEYBRIDGE, Surrey	E. P. Attfield, 105-108 Outlands Drive.
WEYMOUTH	Pankhurst (Weymouth) Ltd., The Palladium, Town Bridge.
WIGAN	S. M. Miller, 74 Scholes.
WINSFORD	Cliff. Dickenson, Station Road.
WINCHESTER, Hants.	Fair, Small, 37 Middle Brook Street.
WOLVERHAMPTON	Chas. E. Cope & Sons Ltd., 169 Stafford Street.
WORCESTER	W. J. Bladder & Son Ltd., 52 Silbury.
WORKSOP, Notts.	Gateford Motor Services, Gateford Road.
WORTHING, Sussex	F. Wheatlands, 56 Broadwater Street West.
WREXHAM, Denbigh	Border Motor & Cycle Works Ltd., 15 Town Hill.
YEOVIL, Som.	Pankhurst (Weymouth) Ltd., 25-27 Sherborne Road.
YORK	J. D. Shearns, 43-47 Blossom Street.

SCOTLAND

ABERDEEN	Geo. Cheyne (Cycles) Ltd., 147 Holburn Street.
BRECHIN, Forfar	J. Dugan & Son, 3-5 St. Mary's Street.
DUNDEE	Geo. McLean Ltd., 30 Ward Road.
DUNDEE	J. A. Rodger, 12 Tannadise Street.
EDINBURGH 1	J. R. Alexander & Co. Ltd., 16-14 Lothian Road.
GLASGOW C.4	J. R. Alexander & Co. Ltd., 272-286 Gt. Western Road.
KIRKCALDY, Fife	The County Motors Ltd., Junction Road.

NORTHERN IRELAND

BELFAST	McIntyre Bros. (Belfast) Ltd., 52-58 May Street.
----------------	--

CHANNEL ISLES

GUERNSEY	H. C. Tosteyke, Grande Rue Motor & Cycle Works, St. Martins.
JERSEY	Bisson, 59 Halkett Place.

Spares Stockists only

LONDON W.5	Kays of Ealing Ltd., 8-10 Bond Street, Ealing.
LONDON W.12	Turners Stores, 81-83 Goldhawk Road, Shepherds Bush.

SERVICE NOTES